

TECHNICAL SPECIFICATIONS



L3IP4BS



L3IP4BS

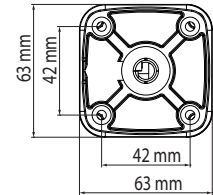
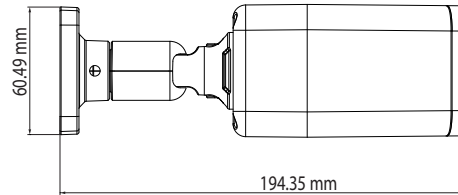

FEATURES:

- ◆ NDAA Compliant
- ◆ Supports AI Face, Body & Vehicle Recognition*
- ◆ True 120dB Wide Dynamic Range
- ◆ 4MP Resolution (2592 x 1520)
- ◆ Fixed 2.8mm IR Lens
- ◆ 4 High Power IR LED - 100' IR Range
- ◆ 7 Intelligent Analytics
- ◆ 256GB SD Card Capability
- ◆ H.265 Recording Compression
- ◆ Audio Line In/Out & Alarm
- ◆ PoE - Power over Ethernet
- ◆ Onvif Profile S/G/T Compliant
- ◆ IP67 Weatherproof

INCLUDED ACCESSORIES:

- 1x Quick start guide
- 1x Hex wrench
- 4x Mounting inserts & screws
- 1x Mounting template
- 1x Network cable cover w/gasket
- 1x 4 Pin Terminal block

	FEATURES	L3IP4BS
Camera	Image Sensor	1/2.8" Progressive Scan CMOS
	Minimum Illumination	Color: 0.01Lux @(F1.2,AGC ON) , B/W: 0Lux @(IR LED ON)
	S/N Ratio	55dB
	IR LED Count / Range / Nanometer	4 High Power IR LED's / 100' Range / 850nm
	Shutter Time	1/5s - 1/20,000s
	Lens (IR Corrective)	Fixed 2.8mm - Angle of View 105°
	Camera Bracket Adjustment	Pan: 0°~360°, Tilt: 0°~90°, Rotation: 0°~360°
	Day & Night	Yes - True Day/Night with IR Filter - Auto Switch
	DNR (Digital Noise Reduction)	2DNR & 3DNR, Auto / Manual (0-100 Adjustable)
	True Wide Dynamic Range (120dB)	On / Off (0-100 Adjustable)
	BLC (Backlight Compensation)	On / Off (0-100 Adjustable)
	AI Recognition	* Face, Body & Vehicle Recognition for use with Liberty L3 Series NVRs
	Intelligent Analytic Features	Perimeter, Single Virtual Fence, Double Virtual Fence, Multi Loitering, Wrong Way, People Counting, Smart Motion
	Region of Interest	Yes
Resolution/Bitrate	Video Compression	H.265, H.264, MJPEG (for all stream types)
	Audio Compression	G.711, RAW_PCM
	General Functions	Supports Mirror, Aisle Mode, Smart IR, Password Protection, Privacy Mask, Motion Detection
	Max. Resolution	2592 x 1520 (4MP)
	Mainstream Resolution / FPS	2592x1520, 2560x1440, 2304x1296, 1920x1080, 1280x720 @25/30FPS
	Substream Resolution / FPS	D1, VGA, 640x360, CIF, QVGA @25/30fps
Network	Third Stream Resolution / FPS	VGA, CIF, QVGA @25/30FPS
	Audio Bitrate	8kbps, 16kbps, 64kbps
	Video Bitrate	Main: 500kbps ~ 12000kbps
		Sub: 100kbps ~ 6000kbps
Third: 100kbps ~ 3000kbps		
Interface	Protocols	IPv4/IPv6, 802.1x, HTTP, HTTPS, TCP/IP, UDP/IP, RTSP, DHCP, NTP, RTCP/RTSP, PPPoE, SMTP, DNS, UPnP, FTP, ARP, SNMP
	Users	Up to 10 Users
	Client Software	Liberty CMS, Liberty-View Mobile App, Liberty Tools
	Web Browser	<IE11, Chrome, Safari, Edge
	Communication Interface	1 Ethernet (10/100 Base-T) RJ-45 Connector
General	Audio	1Ch Input/Output (3.5mm)
	Alarm	1Ch Input/Output (Screw Terminal Connector)
	Reset Button	Yes
	Onboard Storage	Yes Built in Micro SD/SDHC/SDXC slot, up to 256GB
	Operating Conditions	-40°C ~ 55°C (-40°F ~ 131°F) , Less than 90% RH
	Power Supply	12VDC / POE (IEEE 802.3af)
	Power Consumption & Current	3.5W (IR LED OFF), 8W Max (IR LED ON)
	Weatherproof Rating	IP67
	Housing Material / Color	Aluminum / White
	Overall Camera Dimensions	7.7" x 2.5" x 2.5" (194.4 x 63 x 63mm)
Net Weight	1.32lb / 600g	
Certifications	CE / FCC / NDAA	

TECHNICAL SPECIFICATIONS



L3IP4BS

Optional Mounting Accessories for L3IP4BS:

L3JB1 Junction box

Features:

- ◆ Manages & Protects Cables
- ◆ 3/4" Conduit Access
- ◆ For Indoor & Outdoor Use



L3JB1

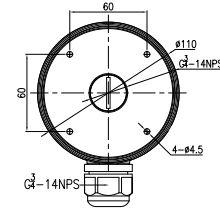
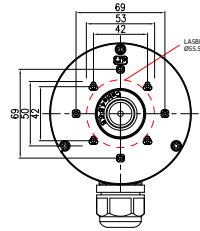

L3JB1 Lineart

L3POLEMT2 Pole mount

Features:

- ◆ Metal Straps Included
- ◆ For 5-6" Pole Diameters
- ◆ For Indoor & Outdoor Use



L3POLEMT2

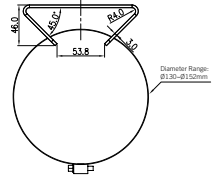
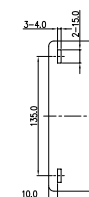
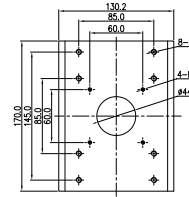

L3POLEMT2 Lineart

TECHNICAL SPECIFICATIONS



L3IP4DS

4mm L3IP4DS4



L3IP4DS / L3IP4DS4

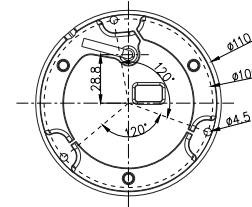
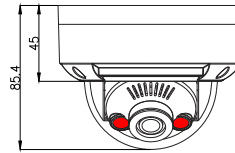

FEATURES:

- ◆ NDAA Compliant
- ◆ Supports AI Face, Body & Vehicle Recognition*
- ◆ True 120dB Wide Dynamic Range
- ◆ 4MP Resolution (2592 x 1520)
- ◆ Fixed 2.8mm or 4mm IR Lens
- ◆ 2 High Power IR LED - 100' IR Range
- ◆ 7 Intelligent Analytics
- ◆ 256GB SD Card Capability
- ◆ H.265 Recording Compression
- ◆ Audio Line In/Out & Alarm
- ◆ PoE - Power over Ethernet
- ◆ Onvif Profile S/G/T Compliant
- ◆ IK10 Rated & IP67 Weatherproof

INCLUDED ACCESSORIES:

- 1x Quick start guide
- 1x T10 Wrench
- 3x Mounting inserts & screws
- 1x Mounting template
- 1x Network cable cover w/gasket
- 1x 4 Pin Terminal block

	FEATURES	L3IP4DS	L3IP4DS4
Camera	Image Sensor	1/2.8" Progressive Scan CMOS	
	Minimum Illumination	Color: 0.01Lux @(F1.2,AGC ON) , B/W: 0Lux @(IR LED ON)	
	S/N Ratio	55dB	
	IR LED Count / Range / Nanometer	2 High Power IR LED's / 100' Range / 850nm	
	Shutter Time	1/5s - 1/20,000s	
	Lens (IR Corrective)	Fixed 2.8mm - Angle of View 105°	Fixed 4mm - Angle of View 85°
	Camera Bracket Adjustment	Pan: 0°~350°, Tilt: 0°~75°, Rotation: ±90°	
	Day & Night	Yes - True Day/Night with IR Filter - Auto Switch	
	DNR (Digital Noise Reduction)	2DNR & 3DNR, Auto / Manual (0-100 Adjustable)	
	True Wide Dynamic Range (120dB)	On / Off (0-100 Adjustable)	
	BLC (Backlight Compensation)	On / Off (0-100 Adjustable)	
	AI Recognition	* Face, Body & Vehicle Recognition for use with Liberty L3 Series NVRs	
	Intelligent Analytic Features	Perimeter, Single Virtual Fence, Double Virtual Fence, Multi Loitering, Wrong Way, People Counting, Smart Motion	
	Region of Interest	Yes	
Video Compression	H.265, H.264, MJPEG (for all stream types)		
Audio Compression	G.711, RAW_PCM		
General Functions	Supports Mirror, Aisle Mode, Smart IR, Password Protection, Privacy Mask, Motion Detection		
Resolution/Bitrate	Max. Resolution	2592 x 1520 (4MP)	
	Mainstream Resolution / FPS	2592x1520, 2560x1440, 2304x1296, 1920x1080, 1280x720 @25/30FPS	
	Substream Resolution / FPS	D1, VGA, 640x360, CIF, QVGA @25/30fps	
	Third Stream Resolution / FPS	VGA, CIF, QVGA @25/30FPS	
	Audio Bitrate	8kbps, 16kbps, 64kbps	
Video Bitrate	Main: 500kbps ~ 12000kbps		
	Sub: 100kbps ~ 6000kbps		
	Third: 100kbps ~ 3000kbps		
Network	Protocols	IPv4/IPv6, 802.1x, HTTP, HTTPS, TCP/IP, UDP/IP, RTSP, DHCP, NTP, RTCP/ RTP, PPPoE, SMTP, DNS, UPnP, FTP, ARP, SNMP	
	Users	Up to 10 Users	
	Client Software	Liberty CMS, Liberty-View Mobile App, Liberty Tools	
	Web Browser	<IE11, Chrome, Safari, Edge	
Interface	Communication Interface	1 Ethernet (10/100 Base-T) RJ-45 Connector	
	Audio	1Ch Input/Output (3.5mm)	
	Alarm	1Ch Input/Output (Screw Terminal Connector)	
	Reset Button	Yes	
	Onboard Storage	Yes Built in Micro SD/SDHC/SDXC slot, up to 256GB	
	General	Operating Conditions	-40°C ~ 55°C (-40°F ~ 131°F) , Less than 90% RH
Power Supply		12VDC / POE (IEEE 802.3af)	
Power Consumption & Current		3.5W (IR LED OFF), 8W Max (IR LED ON)	
Weatherproof/ Impact Ratings		IP67 / IK10	
Housing Material / Color		Aluminum / White	
Overall Camera Dimensions		Ø4.3" x 3.4" (Ø110 x 85.4mm)	
Net Weight		1.04lb / 470g	
Certifications		CE / FCC / NDAA	

TECHNICAL SPECIFICATIONS



L3IP4DS



L3IP4DS4

Optional Mounting Accessories for L3IP4DS | L3IP4DS4:

L3JB2 Junction box

Features:

- ◆ Manages & Protects Cables
- ◆ 3/4" Conduit Access
- ◆ For Indoor & Outdoor Use



L3JB2

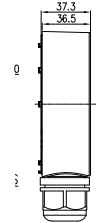
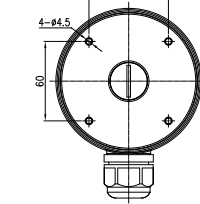
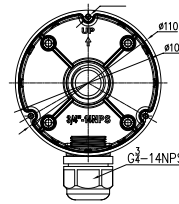

L3JB2 Lineart

L3HWM1 Wall mount

Features:

- * Requires L3PC2 Pendant Cap
- ◆ Manages & Protects Cables
- ◆ Hinged Wall Arm for Easy Installation
- ◆ Side, Back & Bottom 3/4" Conduit Access
- ◆ For Indoor & Outdoor Use



L3HWM1

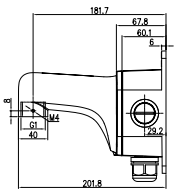
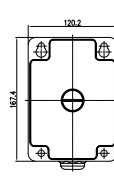
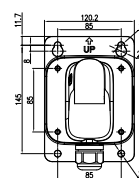
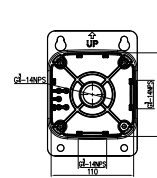

L3HWM1 Lineart

L3PC2 Pendant cap

Features:

- ◆ Pendant Mount for Dome Camera
- ◆ Aluminum Alloy
- ◆ For Indoor & Outdoor Use



L3PC2

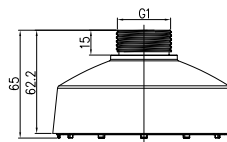

L3PC2 Lineart

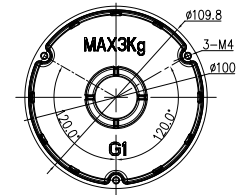

L3CPM1 Pendant mount

Features:

- * Requires L3PC2 Pendant Cap
- ◆ 18" Drop Down Length
- ◆ For Use With or Without Drop Down Pipes
- ◆ Includes (2) 9" Drop Down Pipes
- ◆ Manages & Protects Cables
- ◆ For Indoor & Outdoor Use



L3CPM1

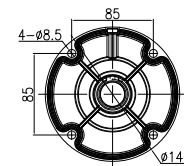
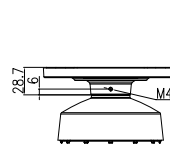

L3CPM1 Lineart



L3POLEMT2 Pole mount

Features:

- ◆ Metal Straps Included
- ◆ For 5-6" Pole Diameters
- ◆ For Indoor & Outdoor Use



L3POLEMT2

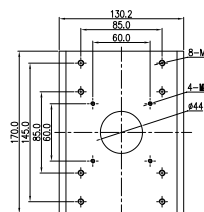

L3POLEMT2 Lineart

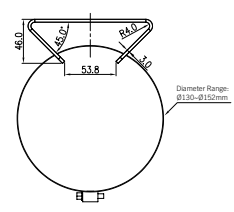
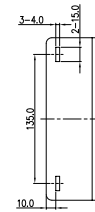

TECHNICAL SPECIFICATIONS



L3IP4PTZ30XS

FEATURES:

- ◆ NDAA Compliant
- ◆ Supports AI Face, Body & Vehicle Recognition*
- ◆ True 120dB Wide Dynamic Range
- ◆ 4MP Resolution (2592 x 1520)
- ◆ 30x Optical Zoom (5.3 ~ 159mm)
- ◆ 10 High Power IR LED - 600' IR Range
- ◆ 7 Intelligent Analytics
- ◆ Intelligent Auto Tracking
- ◆ 360° Endless Panning
- ◆ 400 Preset Positions
- ◆ 6 Tracks, 12 Tours, 12 Scans
- ◆ 7 Alarm Inputs / 2 Outputs
- ◆ -40° Operating Temp
- ◆ Built-in Heater & Fan
- ◆ Includes Wall Mount & DC36V Power Supply
- ◆ 256GB SD Card Capability
- ◆ H.265 Recording Compression
- ◆ Audio Line In/Out & Alarm
- ◆ PoE - Power over Ethernet & 36VDC
- ◆ Onvif Profile S/G/T Compliant
- ◆ IP66 Weatherproof

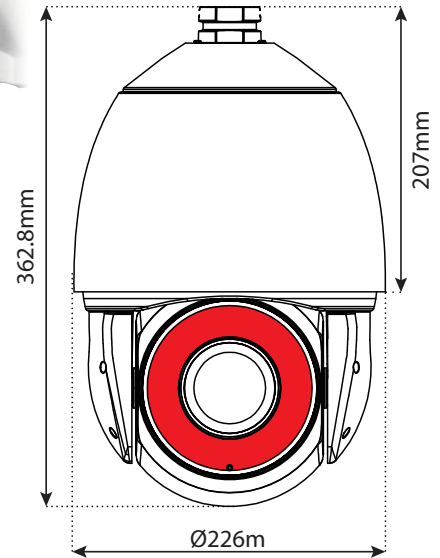

L3IP4PTZ30XS

INCLUDED ACCESSORIES:

- 1x Quick start guide
- 3x Hex socket screws
- 2x Hex wrench
- 3x Mounting inserts & screws
- 1x 36VDC Power Adapter
- 1x Wall mount
- 2x Glove
- 3x Terminal block
- 1x Threaded mount adapter 1.5" NPT
- 1x Safety wire

WALL MOUNT DIMENSIONS

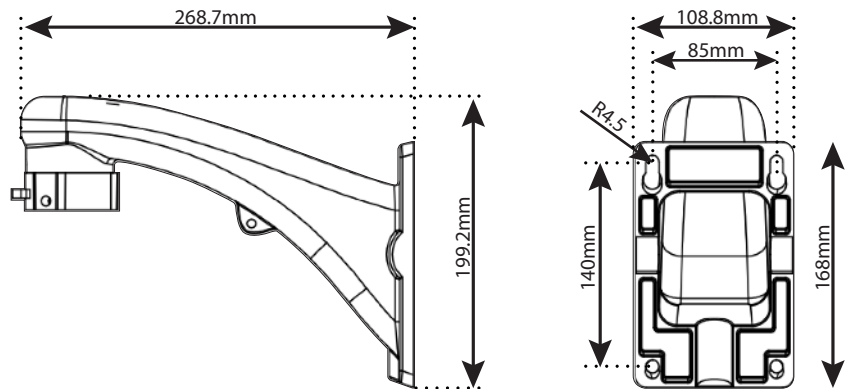



L3IP4PTZ30XS

	SPECIFICATION	L3IP4PTZ30XS
Camera	Image Sensor	1/2.8" Progressive Scan CMOS
	Image Resolution	4 Megapixel, 2592 x 1520 Max
	Min. Illumination	Color: 0.07Lux @(F1.6, AGC ON), B/W: 0.0 Lux (IR LED ON)
	White Balance	Auto / Tungsten / Daylight / Manual (Red & Blue Gain Adjustable)
	AGC	Auto / Manual (0 - 100 Adjustable)
	S/N Ratio	50dB
	2DNR & 3DNR	Auto / Manual (0 - 100 Adjustable)
	BLC & HLC	Yes (0 - 100 Adjustable)
	True WDR	Yes 120dB (0 - 100 Adjustable)
	Defog	Yes (0 - 100 Adjustable)
	Shutter Speed	Auto / Manual, 1/5 - 1/20,000s
	True Day & Night	Yes - Mechanical IR Cut Filter
	Optical / Digital Zoom	30X Optical Zoom - 16x Digital Zoom
	Privacy Mask	Yes - On / Off, 4 Area, Size & Color Adjustable
	Focus Mode	Auto, Manual, Semi-Auto, Sensitivity Adjustable (0 - 100)
AI Recognition	* Face, Body & Vehicle Recognition for use with Liberty L3 Series NVRs	
Intelligent Analytic Features	Perimeter, Single Virtual Fence, Double Virtual Fence, Multi Loitering, Wrong Way, People Counting, Smart Motion	
Auto Tracking	Yes	
Lens	Focal Length	5.3 ~ 159mm, F1.6 ~ F4.3
	Zoom Speed	Approx. 4 sec. (Optical, Wide-Tele)
	Angle of View	H: 55.23° ~ 2.67°, V: 31.61° ~ 1.62°
	Min. Working Distance	1.5 Meters
Pan & Tilt	Pan / Tilt Range	Pan: 0° ~ 360° endless, Tilt: -10° ~ +90°
	Pan / Tilt Speed	Manual: Pan: 0.1° ~ 300°/s, Tilt: 0.1° ~ 300°/s, Preset: Pan: 300°/s, Tilt: 90°/s
	Proportional Zoom	Rotation Speed Adjusted Automatically According to Zoom
	Number of Presets	400
	Idle Action	Time: (1-240 minutes) Activates: Preset / Scan / Tour / Track if no command in the specified period
	Track / Tour / Scan	6 -Tracks (Custom Pattern) / 12 Tours (Preset Pos.) / 12 Scans (Custom Pattern)
	Power-off Memory	On/Off - Preset, Scan, Track, Tour Selectable
	Position Display	Yes
Scheduled Tasks	Up to 8/Day Preset, Scan, Track, Tour	
Input / Output	Alarm Input / Output	7 Ch Input / 2 Ch Output
	Alarm Trigger	Perimter, Single & Double Virtual Fence, Loiter, Object Left & Removal
	Alarm Actions	Preset, Track, Tour, Scan, Recording, Relay Output, Email Linkage
	Audio Input / Output	1x RCA Female / 1x RCA Female
	RS485	Supports
Network	Ethernet	1 Ethernet (10/100 Base-T) RJ-45 Connector
	Frame Rate	Stream 1: 2592x1520, 2560x1440, 2304x1296, 1920x1080, 1280x720 @ 25/30fps Bitrate: 100kbps~12Mbps
		Stream 2: D1, VGA, 640x360, CIF @ 25/30fps Bitrate: 100kbps~6Mbps
		Stream 3: VGA, CIF, QVGA @ 25/30fps Bitrate: 100kbps~3Mbps
	Compression	H.265, H.264, MJPEG
	ROI	Yes
	Audio Compression	G.711 (8kbps), RAW_PCM (16kbps)
	Protocols	IPv4, IPv6, TCP/IP, HTTP, HTTPS, RTSP / RTP / RTCP, IGMP / Multicast, SMTP, DHCP, NTP, DNS, DDNS,, QoS, SNMP, 802.1X, UDP, ICMP, ARP, TLS, Onvif
	Simultaneous View	10 Max
	SD Card	Yes - Micro SD card slot - 256GB Max (Card not included)
	Users	10 Max
Security	User Authentication (ID & Password), IP Filter (Black/White List), HTTPS	
Web Browser	<IE11, Chrome, Safari, Edge	
General	Power Input	AC24V/ DC36V/Hi-POE
	Power Consumption	Less than 45W
	Operating Temp	-40°C ~ 60°C (-40°F ~ 140 °F)
	Protection Level	IP66, TVS4000V
	Dimensions	Ø226x362.8mm (8.9" x 14.28")
	Certifications	CE / FCC / NDAA
Net Weight	5.5 kg (12.1 lb)	

TECHNICAL SPECIFICATIONS



L3IP4PTZ30XS

Optional Mounting Accessories for L3IP4PTZ30XS:

L3PTZJB Junction box

Features:

- ◆ Manages & Protects Cables
- ◆ Hinged Door for Easy Installation
- ◆ 3/4" Conduit Access
- ◆ For Indoor & Outdoor Use



L3PTZJB

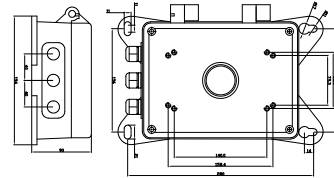

L3PTZJB Lineart

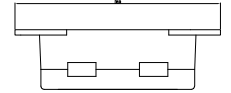

L3PTZPENDMT Pendant cap

Features:

- ◆ Pendant Mount for Dome Camera
- ◆ Aluminum Alloy
- ◆ For Indoor & Outdoor Use



L3PTZPENDMT

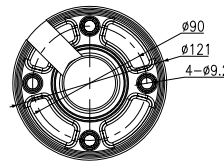

L3PTZPENDMT Lineart

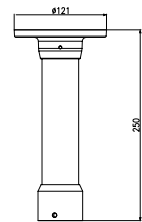

L3PTZCRNMT Outside corner mount

Features:

- ◆ For Indoor & Outdoor Use
- ◆ Heavy Duty Steel Construction



L3PTZCRNMT

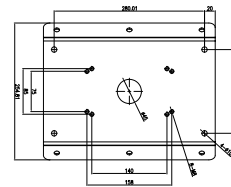

L3PTZCRNMT Lineart

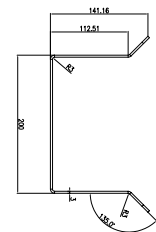

L3PTZPOLEMT Pole mount

Features:

- ◆ Metal Straps Included
- ◆ For 7-8" Pole Diameters
- ◆ For Indoor & Outdoor Use



L3PTZPOLEMT

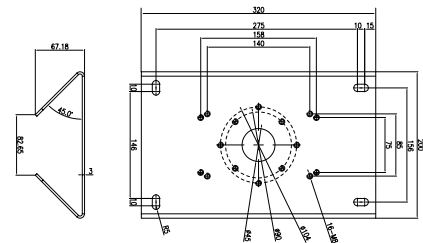

L3PTZPOLEMT Lineart

TECHNICAL SPECIFICATIONS



L3IP4TFCS



L3IP4TFCS

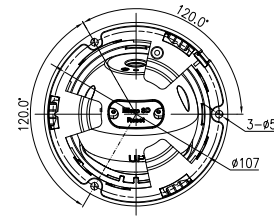
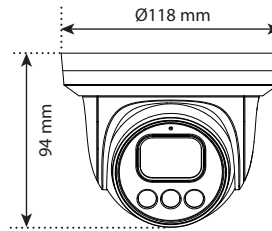

FEATURES:

- ◆ NDAA Compliant
- ◆ Supports AI Face, Body & Vehicle Recognition*
- ◆ True 120dB Wide Dynamic Range
- ◆ 4MP Resolution (2560x1440)
- ◆ Fixed 2.8mm Lens
- ◆ Full Color, 3 White Light LED - 100' Range
- ◆ 7 Intelligent Analytics
- ◆ 256GB SD Card Capability
- ◆ H.265 Recording Compression
- ◆ Built in Mic & Alarm
- ◆ PoE - Power over Ethernet
- ◆ Onvif Profile S/G/T Compliant
- ◆ IP66 Weatherproof

INCLUDED ACCESSORIES:

- 1x Quick start guide
- 3x Mounting inserts & screws
- 1x Mounting template
- 1x Network cable cover w/gasket
- 1x 4 Pin Terminal block

	FEATURES	L3IP4TFCS
Camera	Image Sensor	1/1.8" Progressive Scan CMOS
	Minimum Illumination	Color: 0.0005 Lux @ (F1.0, AGC ON), 0.0 Lux with white light On
	S/N Ratio	55dB
	IR LED Count / Range	3 White Light LEDs / 100' Range
	Shutter Time	1/5s - 1/20,000s
	Lens (IR Corrective)	Fixed 2.8mm - Angle of View 105°
	Camera Bracket Adjustment	Pan: 0° ~ 355°, Tilt: 0° ~ 80°, Rotation: 0° ~ 360°
	Day & Night	Yes - True Day/Night with IR Filter - Auto Switch
	DNR (Digital Noise Reduction)	2DNR & 3DNR, Auto / Manual (0-100 Adjustable)
	True Wide Dynamic Range (120dB)	On / Off (0-100 Adjustable)
	BLC (Backlight Compensation)	On / Off (0-100 Adjustable)
	AI Recognition	* Face, Body & Vehicle Recognition for use with Liberty L3 Series NVRs
	Intelligent Analytic Features	Perimeter, Single Virtual Fence, Double Virtual Fence, Multi Loitering, Wrong Way, People Counting, Smart Motion
	Region of Interest	Yes
Resolution/Bitrate	Video Compression	H.265, H.264, MJPEG (for all stream types)
	Audio Compression	G.711, RAW_PCM
	General Functions	Supports Mirror, Aisle Mode, Smart IR, Password Protection, Privacy Mask, Motion Detection
	Max. Resolution	2560x1440 (4MP)
	Mainstream Resolution / FPS	2560x1440, 2304x1296, 1920x1080, 1280x720 @25/30FPS
	Substream Resolution / FPS	D1, VGA, 640x360, CIF @25/30fps
	Third Stream Resolution / FPS	VGA, CIF, QVGA @25/30FPS
Network	Audio Bitrate	8kbps, 16kbps, 64kbps
	Video Bitrate	Main: 200kbps~12Mbps
		Sub: 100kbps~6Mbps
		Third: 100kbps~3Mbps
Protocols	IPv4/IPv6, 802.1x, HTTP, HTTPS, TCP/IP, UDP/IP, RTSP, DHCP, NTP, RTCP/RTP, PPPoE, SMTP, DNS, UPnP, FTP, ARP, SNMP	
Users	Up to 10 Users	
Client Software	Liberty CMS, Liberty-View Mobile App, Liberty Tools	
Web Browser	<IE11, Chrome, Safari, Edge	
Interface	Communication Interface	1 Ethernet (10/100 Base-T) RJ-45 Connector
	Audio	1Ch Input/Output (3.5mm) Built in Mic
	Alarm	1Ch Input/Output (Screw Terminal Connector)
	Reset Button	Yes
	Onboard Storage	Yes Built in Micro SD/SDHC/SDXC slot, up to 256GB
General	Operating Conditions	-40°C ~ 55°C (-40°F ~ 131°F), Less than 90% RH
	Power Supply	12VDC / POE (IEEE 802.3af)
	Power Consumption & Current	3.5W (LED OFF), 6W Max (LED ON)
	Weatherproof/ Impact Ratings	IP66
	Housing Material / Color	Aluminum / White
	Overall Camera Dimensions	Ø4.6" x 3.7" (Ø118x94mm)
	Net Weight	1.2lb / .55kg
Certifications	CE / FCC / NDAA	

TECHNICAL SPECIFICATIONS



L3IP4TFCS

Optional Mounting Accessories for L3IP4TFCS:

L3JB3 Junction box

Features:

- ◆ Manages & Protects Cables
- ◆ 3/4" Conduit Access
- ◆ For Indoor & Outdoor Use



L3JB3

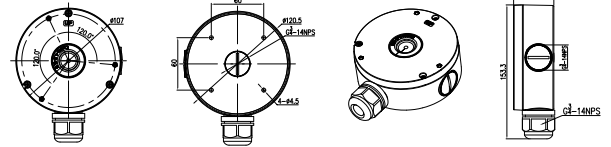

L3JB3 Lineart

L3HWM1 Wall mount

Features:

- * Requires L3PC3 Pendant Cap
- ◆ Manages & Protects Cables
- ◆ Hinged Wall Arm for Easy Installation
- ◆ Side, Back & Bottom 3/4" Conduit Access
- ◆ For Indoor & Outdoor Use



L3HWM1

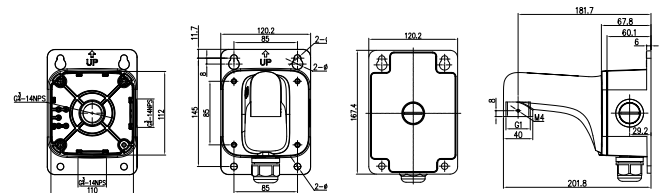

L3HWM1 Lineart

L3PC3 Pendant cap

Features:

- ◆ Pendant Mount for Dome Camera
- ◆ Aluminum Alloy
- ◆ For Indoor & Outdoor Use



L3PC3

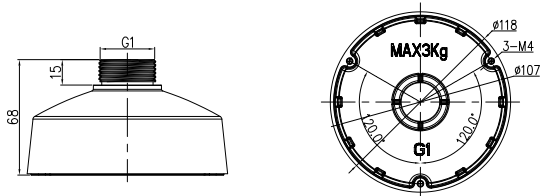

L3PC3 Lineart

L3CPM1 Pendant mount

Features:

- * Requires L3PC3 Pendant Cap
- ◆ 18" Drop Down Length
- ◆ For Use With or Without Drop Down Pipes
- ◆ Includes (2) 9" Drop Down Pipes
- ◆ Manages & Protects Cables
- ◆ For Indoor & Outdoor Use



L3CPM1

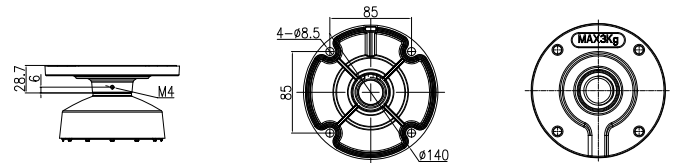

L3CPM1 Lineart

L3POLEMT2 Pole mount

Features:

- ◆ Metal Straps Included
- ◆ For 5-6" Pole Diameters
- ◆ For Indoor & Outdoor Use



L3POLEMT2

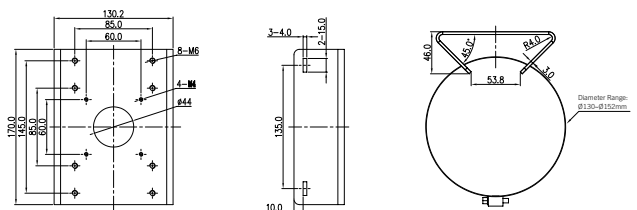

L3POLEMT2 Lineart

TECHNICAL SPECIFICATIONS

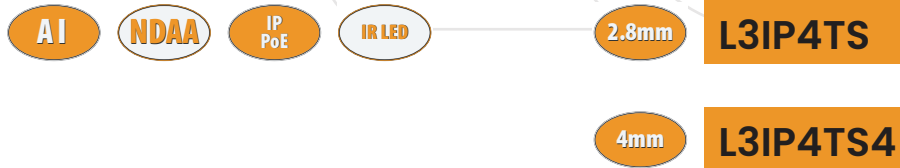

L3IP4TS/ L3IP4TS4

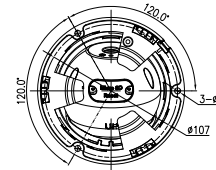
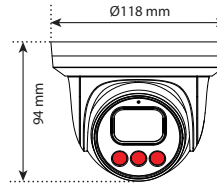

FEATURES:

- ◆ NDAA Compliant
- ◆ Supports AI Face, Body & Vehicle Recognition*
- ◆ True 120dB Wide Dynamic Range
- ◆ 4MP Resolution (2592 x 1520)
- ◆ Fixed 2.8mm or 4mm IR Lens
- ◆ 3 High Power IR LED - 100' IR Range
- ◆ 7 Intelligent Analytics
- ◆ 256GB SD Card Capability
- ◆ H.265 Recording Compression
- ◆ Built in Mic & Alarm
- ◆ PoE - Power over Ethernet
- ◆ Onvif Profile S/G/T Compliant
- ◆ IP66 Weatherproof

INCLUDED ACCESSORIES:

- 1x Quick start guide
- 3x Mounting inserts & screws
- 1x Mounting template
- 1x Network cable cover w/gasket
- 1x 4 Pin Terminal block

	FEATURES	L3IP4TS	L3IP4TS4	
Camera	Image Sensor	1/2.8" Progressive Scan CMOS		
	Minimum Illumination	Color: 0.01Lux @(F1.2,AGC ON) , B/W: 0Lux @(IR LED ON)		
	S/N Ratio	55dB		
	IR LED Count / Range / Nanometer	3 High Power IR LEDs / 100' Range / 850nm		
	Shutter Time	1/5s - 1/20,000s		
	Lens (IR Corrective)	Fixed 2.8mm - Angle of View 105°	Fixed 4mm - Angle of View 85°	
	Camera Bracket Adjustment	Pan: 0°~355°, Tilt: 0°~80°, Rotation: 0°~360°		
	Day & Night	Yes - True Day/Night with IR Filter - Auto Switch		
	DNR (Digital Noise Reduction)	2DNR & 3DNR, Auto / Manual (0-100 Adjustable)		
	True Wide Dynamic Range (120dB)	On / Off (0-100 Adjustable)		
	BLC (Backlight Compensation)	On / Off (0-100 Adjustable)		
	AI Recognition	* Face, Body & Vehicle Recognition for use with Liberty L3 Series NVRs		
	Intelligent Analytic Features	Perimeter, Single Virtual Fence, Double Virtual Fence, Multi Loitering, Wrong Way, People Counting, Smart Motion		
	Region of Interest	Yes		
Video Compression	H.265, H.264, MJPEG (for all stream types)			
Audio Compression	G.711, RAW_PCM			
General Functions	Supports Mirror, Aisle Mode, Smart IR, Password Protection, Privacy Mask, Motion Detection			
Resolution/Bitrate	Max. Resolution	2592 x 1520 (4MP)		
	Mainstream Resolution / FPS	2592x1520, 2560x1440, 2304x1296, 1920x1080, 1280x720 @25/30FPS		
	Substream Resolution / FPS	D1, VGA, 640x360, CIF, QVGA @25/30fps		
	Third Stream Resolution / FPS	VGA, CIF, QVGA @25/30FPS		
	Audio Bitrate	8kbps, 16kbps, 64kbps		
Video Bitrate	Main: 500kbps ~ 12000kbps			
	Sub: 100kbps ~ 6000kbps			
	Third: 100kbps ~ 3000kbps			
Network	Protocols	IPv4/IPv6, 802.1x, HTTP, HTTPS, TCP/IP, UDP/IP, RTSP, DHCP, NTP, RTPC/ RTP, PPPoE, SMTP, DNS, UPnP, FTP, ARP, SNMP		
	Users	Up to 10 Users		
	Client Software	Liberty CMS, Liberty-View Mobile App, Liberty Tools		
	Web Browser	<IE11, Chrome, Safari, Edge		
Interface	Communication Interface	1 Ethernet (10/100 Base-T) RJ-45 Connector		
	Audio	1Ch Input/Output (3.5mm) Built in Mic		
	Alarm	1Ch Input/Output (Screw Terminal Connector)		
	Reset Button	Yes		
	Onboard Storage	Yes Built in Micro SD/SDHC/SDXC slot, up to 256GB		
General	Operating Conditions	-40°C ~ 55°C (-40°F ~ 131°F), Less than 90% RH		
	Power Supply	12VDC / POE (IEEE 802.3af)		
	Power Consumption & Current	3.5W (IR LED OFF), 8W Max (IR LED ON)		
	Weatherproof/ Impact Ratings	IP66		
	Housing Material / Color	Aluminum / White		
	Overall Camera Dimensions	Ø4.6" x 3.7" (Ø118x94mm)		
	Net Weight	1.21lb / 550g		
Certifications	CE / FCC / NDAA			

TECHNICAL SPECIFICATIONS



L3IP4TS



L3IP4TS4

Optional Mounting Accessories for L3IP4TS | L3IP4TS4:

L3JB3 Junction box

Features:

- ◆ Manages & Protects Cables
- ◆ 3/4" Conduit Access
- ◆ For Indoor & Outdoor Use



L3JB3

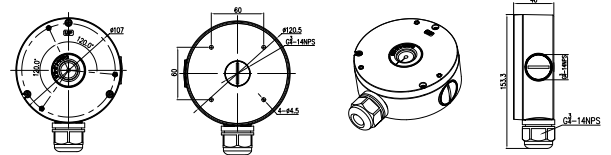

L3JB3 Lineart

L3HWM1 Wall mount

Features:

- * Requires L3PC3 Pendant Cap
- ◆ Manages & Protects Cables
- ◆ Hinged Wall Arm for Easy Installation
- ◆ Side, Back & Bottom 3/4" Conduit Access
- ◆ For Indoor & Outdoor Use



L3HWM1

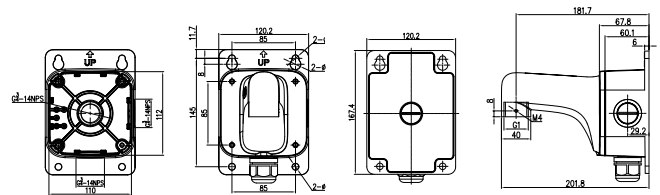

L3HWM1 Lineart

L3PC3 Pendant cap

Features:

- ◆ Pendant Mount for Dome Camera
- ◆ Aluminum Alloy
- ◆ For Indoor & Outdoor Use



L3PC3

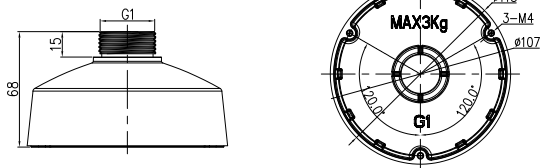

L3PC3 Lineart

L3CPM1 Pendant mount

Features:

- * Requires L3PC3 Pendant Cap
- ◆ 18" Drop Down Length
- ◆ For Use With or Without Drop Down Pipes
- ◆ Includes (2) 9" Drop Down Pipes
- ◆ Manages & Protects Cables
- ◆ For Indoor & Outdoor Use



L3CPM1

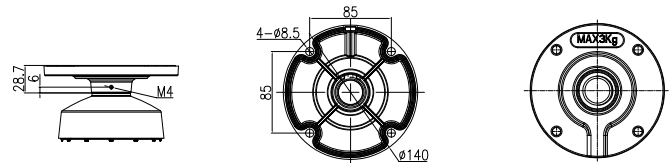

L3CPM1 Lineart

L3POLEMT2 Pole mount

Features:

- ◆ Metal Straps Included
- ◆ For 5-6" Pole Diameters
- ◆ For Indoor & Outdoor Use



L3POLEMT2

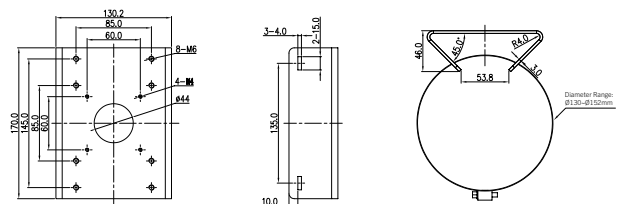

L3POLEMT2 Lineart

TECHNICAL SPECIFICATIONS



L3IP4VFBS



L3IP4VFBS

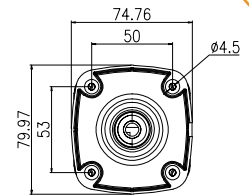
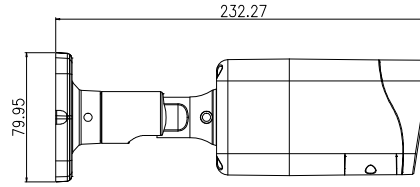

FEATURES:

- ◆ NDAA Compliant
- ◆ Supports AI Face, Body & Vehicle Recognition*
- ◆ True 120dB Wide Dynamic Range
- ◆ 4MP Resolution (2592 x 1520)
- ◆ Auto Focus 2.7 ~ 13.5mm IR Lens
- ◆ 4 High Power IR LED - 120' IR Range
- ◆ 7 Intelligent Analytics
- ◆ 256GB SD Card Capability
- ◆ H.265 Recording Compression
- ◆ Audio Line In/Out & Alarm
- ◆ PoE - Power over Ethernet
- ◆ Onvif Profile S/G/T Compliant
- ◆ IP67 Weatherproof

INCLUDED ACCESSORIES:

- 1x Quick start guide
- 2x Hex wrench
- 4x Mounting inserts & screws
- 1x Mounting template
- 1x Network cable cover w/gasket
- 1x 4 Pin Terminal block

	FEATURES	L3IP4VFBS
Camera	Image Sensor	1/2.8" Progressive Scan CMOS
	Minimum Illumination	Color: 0.01Lux @(F1.2,AGC ON) , B/W: 0Lux @(IR LED ON)
	S/N Ratio	55dB
	IR LED Count / Range / Nanometer	4 High Power IR LED's / 120' Range / 850nm
	Shutter Time	1/5s - 1/20,000s
	Lens (IR Corrective)	Autofocus 2.7-13.5mm with Remote Zoom / H: 34.3° - 103°
	Camera Bracket Adjustment	Pan: 0°~360°, Tilt: 0°~90°, Rotation: 0°~360°
	Day & Night	Yes - True Day/Night with IR Filter - Auto Switch
	DNR (Digital Noise Reduction)	2DNR & 3DNR, Auto / Manual (0-100 Adjustable)
	True Wide Dynamic Range (120dB)	On / Off (0-100 Adjustable)
	BLC (Backlight Compensation)	On / Off (0-100 Adjustable)
	AI Recognition	* Face, Body & Vehicle Recognition for use with Liberty L3 Series NVRs
	Intelligent Analytic Features	Perimeter, Single Virtual Fence, Double Virtual Fence, Multi Loitering, Wrong Way, People Counting, Smart Motion
	Region of Interest	Yes
Resolution/Bitrate	Video Compression	H.265, H.264, MJPEG (for all stream types)
	Audio Compression	G.711, RAW_PCM
	General Functions	Supports Mirror, Aisle Mode, Smart IR, Password Protection, Privacy Mask, Motion Detection
	Max. Resolution	2592 x 1520 (4MP)
	Mainstream Resolution / FPS	2592x1520, 2560x1440, 2304x1296, 1920x1080, 1280x720 @25/30FPS
	Substream Resolution / FPS	D1, VGA, 640x360, CIF, QVGA @25/30fps
Video Bitrate	Third Stream Resolution / FPS	VGA, CIF, QVGA @25/30FPS
	Audio Bitrate	8kbps, 16kbps, 64kbps
	Video Bitrate	Main: 500kbps ~ 12000kbps Sub: 100kbps ~ 6000kbps Third: 100kbps ~ 3000kbps
Network	Protocols	IPv4/IPv6, 802.1x, HTTP, HTTPS, TCP/IP, UDP/IP, RTSP, DHCP, NTP, RTCP/ RTP, PPPoE, SMTP, DNS, UPnP, FTP, ARP, SNMP
	Users	Up to 10 Users
	Client Software	Liberty CMS, Liberty-View Mobile App, Liberty Tools
	Web Browser	<IE11, Chrome, Safari, Edge
Interface	Communication Interface	1 Ethernet (10/100 Base-T) RJ-45 Connector
	Audio	1Ch Input/Output (3.5mm)
	Alarm	1Ch Input/Output (Screw Terminal Connector)
	Reset Button	Yes
	Onboard Storage	Yes Built in Micro SD/SDHC/SDXC slot, up to 256GB
General	Operating Conditions	-40°C ~ 55°C (-40°F ~ 131°F), Less than 90% RH
	Power Supply	12VDC / POE (IEEE 802.3af)
	Power Consumption & Current	3.5W (IR LED OFF), 8W Max (IR LED ON)
	Weatherproof/ Impact Ratings	IP67
	Housing Material / Color	Aluminum / White
	Overall Camera Dimensions	9.1" x 2.9" x 3.1" (232 x 74.8 x 80mm)
	Net Weight	1.5lb / 700g
Certifications	CE / FCC / NDAA	



L3IP4VFBS

Optional Mounting Accessories for L3IP4VFBS:

L3JB1 Junction box

Features:

- ◆ Manages & Protects Cables
- ◆ 3/4" Conduit Access
- ◆ For Indoor & Outdoor Use



L3JB1

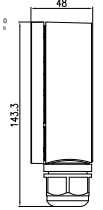
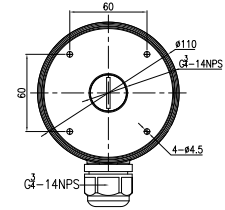
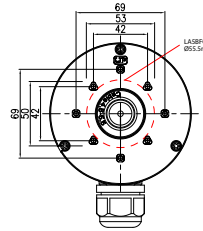

L3JB1 Lineart

L3POLEMT2 Pole mount

Features:

- ◆ Metal Straps Included
- ◆ For 5-6" Pole Diameters
- ◆ For Indoor & Outdoor Use



L3POLEMT2

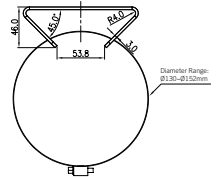
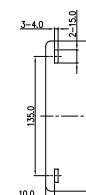
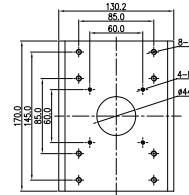

L3POLEMT2 Lineart

TECHNICAL SPECIFICATIONS



L3IP4VFDS



L3IP4VFDS

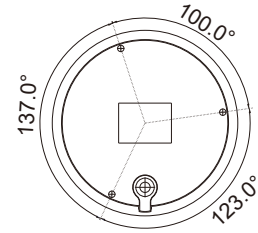
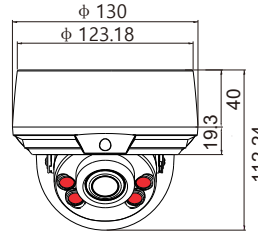

FEATURES:

- ◆ NDAA Compliant
- ◆ Supports AI Face, Body & Vehicle Recognition*
- ◆ True 120dB Wide Dynamic Range
- ◆ 4MP Resolution (2592 x 1520)
- ◆ Auto Focus 2.7 ~ 13.5mm IR Lens
- ◆ 4 High Power IR LED - 120' IR Range
- ◆ 7 Intelligent Analytics
- ◆ 256GB SD Card Capability
- ◆ H.265 Recording Compression
- ◆ Audio Line In/Out & Alarm
- ◆ PoE - Power over Ethernet
- ◆ Onvif Profile S/G/T Compliant
- ◆ IK10 Rated & IP66 Weatherproof

INCLUDED ACCESSORIES:

- 1x Quick start guide
- 1x T15 Wrench
- 3x Mounting inserts & screws
- 3x Mounting accessory screws
- 1x Mounting template
- 1x Network cable cover w/gasket
- 1x 4 Pin Terminal block

	FEATURES	L3IP4VFDS
Camera	Image Sensor	1/2.8" Progressive Scan CMOS
	Minimum Illumination	Color: 0.01Lux @(F1.2,AGC ON) , B/W: 0Lux @(IR LED ON)
	S/N Ratio	55dB
	IR LED Count / Range / Nanometer	4 High Power IR LED's / 120' Range / 850nm
	Shutter Time	1/5s - 1/20,000s
	Lens (IR Corrective)	Autofocus 2.7-13.5mm with Remote Zoom / H: 34.3° - 103°
	Camera Bracket Adjustment	Pan: 0°~355°, Tilt: 0°~75°, Rotation: 0°~355°
	Day & Night	Yes - True Day/Night with IR Filter - Auto Switch
	DNR (Digital Noise Reduction)	2DNR & 3DNR, Auto / Manual (0-100 Adjustable)
	True Wide Dynamic Range (120dB)	On / Off (0-100 Adjustable)
	BLC (Backlight Compensation)	On / Off (0-100 Adjustable)
	AI Recognition	* Face, Body & Vehicle Recognition for use with Liberty L3 Series NVRs
	Intelligent Analytic Features	Perimeter, Single Virtual Fence, Double Virtual Fence, Multi Loitering, Wrong Way, People Counting, Smart Motion
	Region of Interest	Yes
Resolution/Bitrate	Video Compression	H.265, H.264, MJPEG (for all stream types)
	Audio Compression	G.711, RAW_PCM
	General Functions	Supports Mirror, Aisle Mode, Smart IR, Password Protection, Privacy Mask, Motion Detection
	Max. Resolution	2592 x 1520 (4MP)
	Mainstream Resolution / FPS	2592x1520, 2560x1440, 2304x1296, 1920x1080, 1280x720 @25/30FPS
Network	Substream Resolution / FPS	D1, VGA, 640x360, CIF, QVGA @25/30fps
	Third Stream Resolution / FPS	VGA, CIF, QVGA @25/30FPS
	Audio Bitrate	8kbps, 16kbps, 64kbps
Interface	Video Bitrate	Main: 500kbps ~ 12000kbps Sub: 100kbps ~ 6000kbps Third: 100kbps ~ 3000kbps
	Protocols	IPv4/IPv6, 802.1x, HTTP, HTTPS, TCP/IP, UDP/IP, RTSP, DHCP, NTP, RTCP/ RTP, PPPoE, SMTP, DNS, UPnP, FTP, ARP, SNMP
	Users	Up to 10 Users
	Client Software	Liberty CMS, Liberty-View Mobile App, Liberty Tools
General	Web Browser	<IE11, Chrome, Safari, Edge
	Communication Interface	1 Ethernet (10/100 Base-T) RJ-45 Connector
	Audio	1Ch Input/Output (3.5mm)
	Alarm	1Ch Input/Output (Screw Terminal Connector)
	Reset Button	Yes
	Onboard Storage	Yes Built in Micro SD/SDHC/SDXC slot, up to 256GB
	Operating Conditions	-40°C ~ 55°C (-40°F ~ 131°F) , Less than 90% RH
Power Supply	12VDC / POE (IEEE 802.3af)	
Power Consumption & Current	3.5W (IR LED OFF), 8.5W Max (IR LED ON)	
Weatherproof/ Impact Ratings	IP66 / IK10	
Housing Material / Color	Aluminum / White	
Overall Camera Dimensions	Ø5.1" x 4.4" (Ø130 x 112mm)	
Net Weight	1.7lb / 800g	
Certifications	CE / FCC / NDAA	

TECHNICAL SPECIFICATIONS



L3IP4VFDS

Optional Mounting Accessories for L3IP4VFDS:

L3JB5 Junction box

Features:

- ◆ Manages & Protects Cables
- ◆ 3/4" Conduit Access
- ◆ For Indoor & Outdoor Use



L3JB5

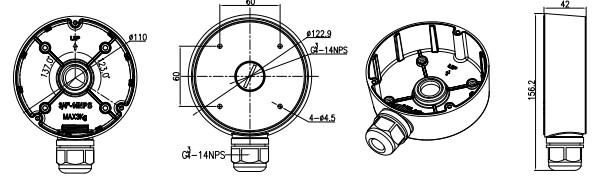

L3JB5 Lineart

L3HWM1 Wall mount

Features:

- * Requires L3PC5 Pendant Cap
- ◆ Manages & Protects Cables
- ◆ Hinged Wall Arm for Easy Installation
- ◆ Side, Back & Bottom 3/4" Conduit Access
- ◆ For Indoor & Outdoor Use



L3HWM1

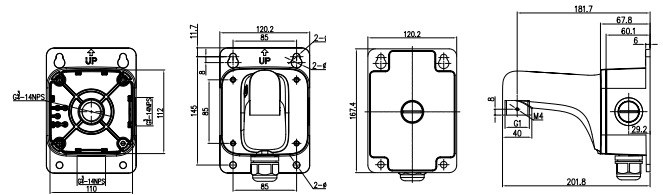

L3HWM1 Lineart

L3PC5 Pendant cap

Features:

- ◆ Pendant Mount for Dome Camera
- ◆ Aluminum Alloy
- ◆ For Indoor & Outdoor Use



L3PC5

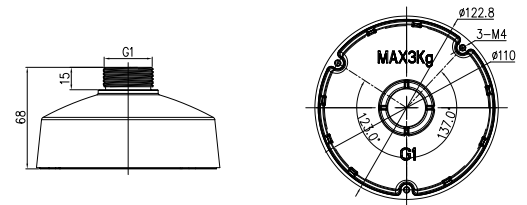

L3PC5 Lineart

L3CPM1 Pendant mount

Features:

- * Requires L3PC5 Pendant Cap
- ◆ 18" Drop Down Length
- ◆ For Use With or Without Drop Down Pipes
- ◆ Includes (2) 9" Drop Down Pipes
- ◆ Manages & Protects Cables
- ◆ For Indoor & Outdoor Use



L3CPM1

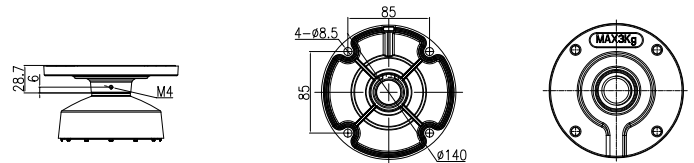

L3CPM1 Lineart

L3POLEMT2 Pole mount

Features:

- ◆ Metal Straps Included
- ◆ For 5-6" Pole Diameters
- ◆ For Indoor & Outdoor Use



L3POLEMT2

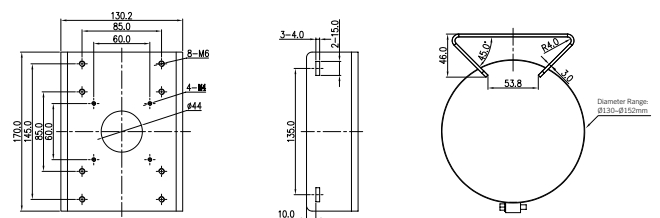

L3POLEMT2 Lineart

TECHNICAL SPECIFICATIONS



L3IP8BS

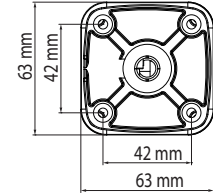
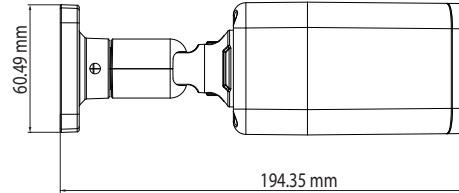

FEATURES:

- ◆ NDAA Compliant
- ◆ Supports AI Face, Body & Vehicle Recognition*
- ◆ True 120dB Wide Dynamic Range
- ◆ 8MP Resolution (3840 x 2160)
- ◆ Fixed 2.8mm IR Lens
- ◆ 4 High Power IR LED - 100' IR Range
- ◆ 7 Intelligent Analytics
- ◆ 256GB SD Card Capability
- ◆ H.265 Recording Compression
- ◆ Audio Line In/Out & Alarm
- ◆ PoE - Power over Ethernet
- ◆ Onvif Profile S/G/T Compliant
- ◆ IP67 Weatherproof

INCLUDED ACCESSORIES:

- 1x Quick start guide
- 1x Hex wrench
- 4x Mounting inserts & screws
- 1x Mounting template
- 1x Network cable cover w/gasket
- 1x 4 Pin Terminal block

	FEATURES	L3IP8BS
Camera	Image Sensor	1/2.8" Progressive Scan CMOS
	Minimum Illumination	Color: 0.01Lux @(F1.6, AGC ON) , B/W: 0Lux @(IR LED ON)
	S/N Ratio	55dB
	IR LED Count / Range / Nanometer	4 High Power IR LED's / 100' Range / 850nm
	Shutter Time	1/5s - 1/20,000s
	Lens (IR Corrective)	Fixed 2.8mm - Angle of View 105°
	Camera Bracket Adjustment	Pan: 0°~360°, Tilt: 0°~90°, Rotation: 0°~360°
	Day & Night	Yes - True Day/Night with IR Filter - Auto Switch
	DNR (Digital Noise Reduction)	2DNR & 3DNR, Auto / Manual (0-100 Adjustable)
	True Wide Dynamic Range (120dB)	On / Off (0-100 Adjustable)
	BLC (Backlight Compensation)	On / Off (0-100 Adjustable)
	AI Recognition	* Face, Body & Vehicle Recognition for use with Liberty L3 Series NVRs
	Intelligent Analytic Features	Perimeter, Single Virtual Fence, Double Virtual Fence, Multi Loitering, Wrong Way, People Counting, Smart Motion
	Region of Interest	Yes
Resolution/BiRate	Video Compression	H.265, H.264, MJPEG (for all stream types)
	Audio Compression	G.711, RAW_PCM
	General Functions	Supports Mirror, Aisle Mode, Smart IR, Password Protection, Privacy Mask, Motion Detection
	Max. Resolution	8MP (3840x2160)
	Mainstream Resolution / FPS	3840x2160, 2592x1944, 2592x1520, 2560x1440, 2304x1296, 1920x1080, 1280x720 @ 25/30fps
	Substream Resolution / FPS	D1, VGA, CIF @25/30fps
Network	Third Stream Resolution / FPS	VGA, CIF, QVGA @25/30FPS
	Audio Bitrate	8kbps, 16kbps, 64kbps
	Video Bitrate	Main: 200kbps ~ 16000kbps
		Sub: 100kbps ~ 6000kbps
Interface	Third: 100kbps ~ 3000kbps	
	Protocols	IPv4/IPv6, 802.1x, HTTP, HTTPS, TCP/IP, UDP/IP, RTSP, DHCP, NTP, RTCP/ RTP, PPPoE, SMTP, DNS, UPnP, FTP, ARP, SNMP
	Users	Up to 10 Users
	Client Software	Liberty CMS, Liberty-View Mobile App, Liberty Tools
	Web Browser	<IE11, Chrome, Safari, Edge
General	Communication Interface	1 Ethernet (10/100 Base-T) RJ-45 Connector
	Audio	1Ch Input/Output (3.5mm)
	Alarm	1Ch Input/Output (Screw Terminal Connector)
	Reset Button	Yes
	Onboard Storage	Yes Built in Micro SD/SDHC/SDXC slot, up to 256GB
	Operating Conditions	-40°C ~ 55°C (-40°F ~ 131°F) , Less than 90% RH
	Power Supply	12VDC / POE (IEEE 802.3af)
	Power Consumption & Current	3.5W (IR LED OFF), 9.5W Max (IR LED ON)
	Weatherproof Rating	IP67
	Housing Material / Color	Aluminum / White
Overall Camera Dimensions	7.7" x 2.5" x 2.5" (194.4 x 63 x 63mm)	
Net Weight	1.32lb / 600g	
Certifications	CE / FCC / NDAA	

TECHNICAL SPECIFICATIONS



L3IP8BS

Optional Mounting Accessories for L3IP8BS:

L3JB1 Junction box

Features:

- ◆ Manages & Protects Cables
- ◆ 3/4" Conduit Access
- ◆ For Indoor & Outdoor Use



L3JB1

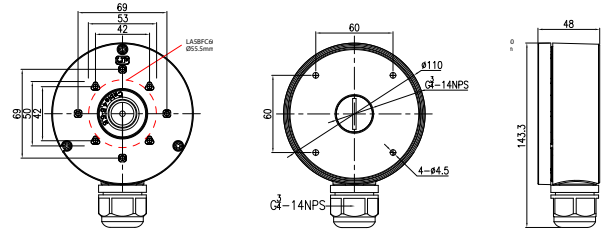

L3JB1 Lineart

L3POLEMT2 Pole mount

Features:

- ◆ Metal Straps Included
- ◆ For 5-6" Pole Diameters
- ◆ For Indoor & Outdoor Use



L3POLEMT2

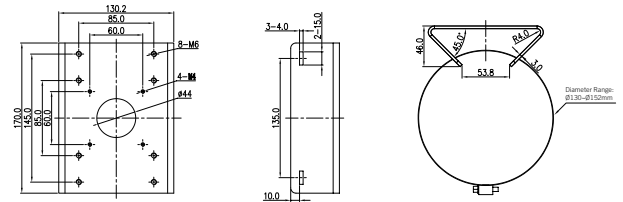

L3POLEMT2 Lineart

TECHNICAL SPECIFICATIONS



L3IP8DS

4mm L3IP8DS4



L3IP8DS / L3IP8DS4

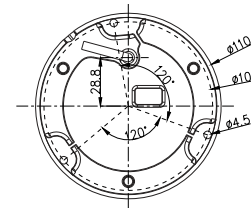
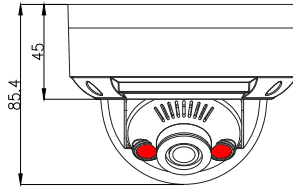

FEATURES:

- ◆ NDAA Compliant
- ◆ Supports AI Face, Body & Vehicle Recognition*
- ◆ True 120dB Wide Dynamic Range
- ◆ 8MP Resolution (3840 x 2160)
- ◆ Fixed 2.8mm or 4mm IR Lens
- ◆ 2 High Power IR LED - 100' IR Range
- ◆ 7 Intelligent Analytics
- ◆ 256GB SD Card Capability
- ◆ H.265 Recording Compression
- ◆ Audio Line In/Out & Alarm
- ◆ PoE - Power over Ethernet
- ◆ Onvif Profile S/G/T Compliant
- ◆ IK10 Rated & IP67 Weatherproof

INCLUDED ACCESSORIES:

- 1x Quick start guide
- 1x T10 Wrench
- 3x Mounting inserts & screws
- 1x Mounting template
- 1x Network cable cover w/gasket
- 1x 4 Pin Terminal block

	FEATURES	L3IP8DS	L3IP8DS4
Camera	Image Sensor	1/2.8" Progressive Scan CMOS	
	Minimum Illumination	Color: 0.01Lux @(F1.6, AGC ON) , B/W: 0Lux @(IR LED ON)	
	S/N Ratio	55dB	
	IR LED Count / Range / Nanometer	2 High Power IR LED's / 100' Range / 850nm	
	Shutter Time	1/5s - 1/20,000s	
	Lens (IR Corrective)	Fixed 2.8mm - Angle of View 105°	Fixed 4mm - Angle of View 85°
	Camera Bracket Adjustment	Pan: 0°~350°, Tilt: 0°~75°, Rotation: ±90°	
	Day & Night	Yes - True Day/Night with IR Filter - Auto Switch	
	DNR (Digital Noise Reduction)	2DNR & 3DNR, Auto / Manual (0-100 Adjustable)	
	True Wide Dynamic Range (120dB)	On / Off (0-100 Adjustable)	
	BLC (Backlight Compensation)	On / Off (0-100 Adjustable)	
	AI Recognition	* Face, Body & Vehicle Recognition for use with Liberty L3 Series NVRs	
	Intelligent Analytic Features	Perimeter, Single Virtual Fence, Double Virtual Fence, Multi Loitering, Wrong Way, People Counting, Smart Motion	
	Region of Interest	Yes	
Video Compression	H.265, H.264, MJPEG (for all stream types)		
Audio Compression	G.711, RAW_PCM		
General Functions	Supports Mirror, Aisle Mode, Smart IR, Password Protection, Privacy Mask, Motion Detection		
Resolution/Bitrates	Max. Resolution	8MP (3840x2160)	
	Mainstream Resolution / FPS	3840x2160, 2592x1944, 2592x1520, 2560x1440, 2304x1296, 1920x1080, 1280x720 @ 25/30fps	
	Substream Resolution / FPS	D1, VGA, 640x360, CIF @25/30fps	
	Third Stream Resolution / FPS	VGA, CIF, QVGA @25/30FPS	
	Audio Bitrate	8kbps, 16kbps, 64kbps	
Video Bitrate		Main: 200kbps ~ 16000kbps	
		Sub: 100kbps ~ 6000kbps	
		Third: 100kbps ~ 3000kbps	
Network	Protocols	IPv4/IPv6, 802.1x, HTTP, HTTPS, TCP/IP, UDP/IP, RTSP, DHCP, NTP, RTPC/RTP, PPPoE, SMTP, DNS, UPnP, FTP, ARP, SNMP	
	Users	Up to 10 Users	
	Client Software	Liberty CMS, Liberty-View Mobile App, Liberty Tools	
	Web Browser	<IE11, Chrome, Safari, Edge	
Interface	Communication Interface	1 Ethernet (10/100 Base-T) RJ-45 Connector	
	Audio	1Ch Input/Output (3.5mm)	
	Alarm	1Ch Input/Output (Screw Terminal Connector)	
	Reset Button	Yes	
	Onboard Storage	Yes Built in Micro SD/SDHC/SDXC slot, up to 256GB	
General	Operating Conditions	-40°C ~ 55°C (-40°F ~ 131°F) , Less than 90% RH	
	Power Supply	12VDC / POE (IEEE 802.3af)	
	Power Consumption & Current	3.5W (IR LED OFF), 6W Max (IR LED ON)	
	Weatherproof/ Impact Ratings	IP67 / IK10	
	Housing Material / Color	Aluminum / White	
	Overall Camera Dimensions	Ø4.3" x 3.4" (Ø110 x 85.4mm)	
	Net Weight	1.04lb / 470g	
Certifications	CE / FCC / NDAA		

TECHNICAL SPECIFICATIONS

8MP NDAA IP PoE IR LED 2.8mm

L3IP8DS

4mm

L3IP8DS4

Optional Mounting Accessories for L3IP8DS | L3IP8DS4:

L3JB2 Junction box

Features:

- ◆ Manages & Protects Cables
- ◆ 3/4" Conduit Access
- ◆ For Indoor & Outdoor Use



L3JB2

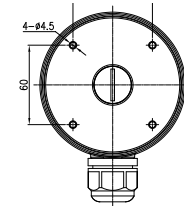
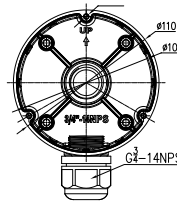

L3JB2 Lineart

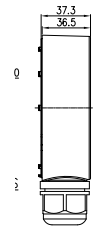

L3HWM1 Wall mount

Features:

- * Requires L3PC2 Pendant Cap
- ◆ Manages & Protects Cables
- ◆ Hinged Wall Arm for Easy Installation
- ◆ Side, Back & Bottom 3/4" Conduit Access
- ◆ For Indoor & Outdoor Use



L3HWM1

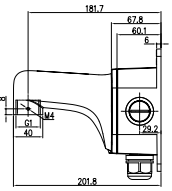
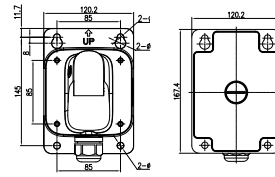
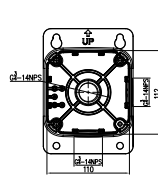

L3HWM1 Lineart

L3PC2 Pendant cap

Features:

- ◆ Pendant Mount for Dome Camera
- ◆ Aluminum Alloy
- ◆ For Indoor & Outdoor Use



L3PC2

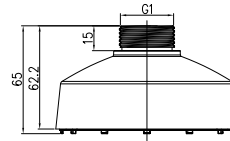

L3PC2 Lineart

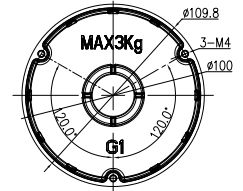

L3CPM1 Pendant mount

Features:

- * Requires L3PC2 Pendant Cap
- ◆ 18" Drop Down Length
- ◆ For Use With or Without Drop Down Pipes
- ◆ Includes (2) 9" Drop Down Pipes
- ◆ Manages & Protects Cables
- ◆ For Indoor & Outdoor Use



L3CPM1

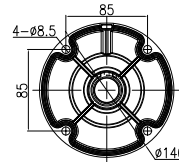
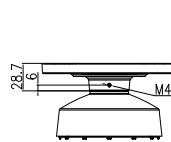

L3CPM1 Lineart



L3POLEMT2 pole mount

Features:

- ◆ Metal Straps Included
- ◆ For 5-6" Pole Diameters
- ◆ For Indoor & Outdoor Use



L3POLEMT2

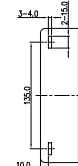
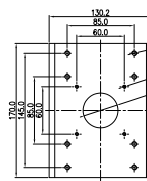

L3POLEMT2 Lineart

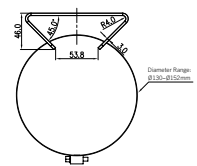

TECHNICAL SPECIFICATIONS



L3IP8TFCS



L3IP8TFCS

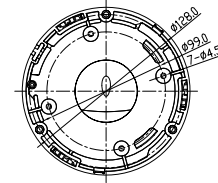
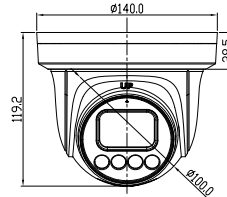

FEATURES:

- ◆ NDAA Compliant
- ◆ Supports AI Face, Body & Vehicle Recognition*
- ◆ True 120dB Wide Dynamic Range
- ◆ 8MP Resolution (3840 x 2160)
- ◆ Fixed 2.8mm Lens
- ◆ Full Color, 4 White Light LED - 100' Range
- ◆ 7 Intelligent Analytics
- ◆ 256GB SD Card Capability
- ◆ H.265 Recording Compression
- ◆ Built in Mic & Alarm
- ◆ PoE - Power over Ethernet
- ◆ Onvif Profile S/G/T Compliant
- ◆ IP66 Weatherproof

INCLUDED ACCESSORIES:

- 1x Quick start guide
- 3x Mounting inserts & screws
- 1x Mounting template
- 1x Network cable cover w/gasket
- 1x 4 Pin Terminal block

	FEATURES	L3IP8TFCS
Camera	Image Sensor	1/1.8" Progressive Scan CMOS
	Minimum Illumination	Color: 0.0005 Lux @ (F1.0, AGC ON), 0.0 Lux with white light On
	S/N Ratio	55dB
	IR LED Count / Range	4 White Light LEDs / 100' Range
	Shutter Time	1/5s - 1/20,000s
	Lens (IR Corrective)	Fixed 2.8mm - Angle of View 105°
	Camera Bracket Adjustment	Pan: 0° ~ 355°, Tilt: 0° ~ 80°, Rotation: 0° ~ 360°
	Day & Night	Yes - True Day/Night with IR Filter - Auto Switch
	DNR (Digital Noise Reduction)	2DNR & 3DNR, Auto / Manual (0-100 Adjustable)
	True Wide Dynamic Range (120dB)	On / Off (0-100 Adjustable)
	BLC (Backlight Compensation)	On / Off (0-100 Adjustable)
	AI Recognition	* Face, Body & Vehicle Recognition for use with Liberty L3 Series NVRs
	Intelligent Analytic Features	Perimeter, Single Virtual Fence, Double Virtual Fence, Multi Loitering, Wrong Way, People Counting, Smart Motion
	Region of Interest	Yes
Resolution/Bitrate	Video Compression	H.265, H.264, MJPEG (for all stream types)
	Audio Compression	G.711, RAW_PCM
	General Functions	"Supports Mirror, Aisle Mode, Smart IR, Password Protection, Privacy Mask, Motion Detection"
	Max. Resolution	8MP (3840x2160)
	Mainstream Resolution / FPS	3840x2160, 2592x1944, 2592x1520, 2560x1440, 2048x1536, 1920x1080, 1280x720 @ 25/30fps
Network	Substream Resolution / FPS	D1, VGA, 640x360, CIF, QVGA @25/30fps
	Third Stream Resolution / FPS	VGA, CIF, QVGA @25/30FPS
	Audio Bitrate	8kbps, 16kbps, 64kbps
Interface	Video Bitrate	Main: 200kbps~16Mbps Sub: 100kbps~6Mbps Third: 100kbps~3Mbps
	Protocols	IPv4/IPv6, 802.1x, HTTP, HTTPS, TCP/IP, UDP/IP, RTSP, DHCP, NTP, RTP/RTP, PPPoE, SMTP, DNS, UPnP, FTP, ARP, SNMP
	Users	Up to 10 Users
	Client Software	Liberty CMS, Liberty-View Mobile App, Liberty Tools
General	Web Browser	<IE11, Chrome, Safari, Edge
	Communication Interface	1 Ethernet (10/100 Base-T) RJ-45 Connector
	Audio	1Ch Input/Output (3.5mm) Built in Mic
	Alarm	1Ch Input/Output (Screw Terminal Connector)
	Reset Button	Yes
	Onboard Storage	Yes Built in Micro SD/SDHC/SDXC slot, up to 256GB
General	Operating Conditions	-40°C ~ 55°C (-40°F ~ 131°F), Less than 90% RH
	Power Supply	12VDC / POE (IEEE 802.3af)
	Power Consumption & Current	3.5W (LED OFF), 8.5W Max (LED ON)
	Weatherproof Rating	IP66
	Housing Material / Color	Aluminum / White
	Overall Camera Dimensions	Ø5.5" x 4.7" (Ø140x119mm)
	Weight	1.98lb / .900kg
Certifications	CE / FCC / NDAA	

TECHNICAL SPECIFICATIONS



L3IP8TFCS

Optional Mounting Accessories for L3IP8TFCS:

L3JB6 Junction box

Features:

- ◆ Manages & Protects Cables
- ◆ 3/4" Conduit Access
- ◆ For Indoor & Outdoor Use



L3JB6

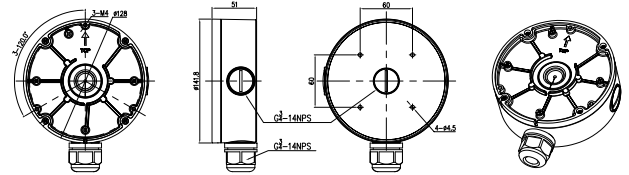

L3JB6 Lineart

L3HWM1 Wall mount

Features:

- * Requires L3PC6 Pendant Cap
- ◆ Manages & Protects Cables
- ◆ Hinged Wall Arm for Easy Installation
- ◆ Side, Back & Bottom 3/4" Conduit Access
- ◆ For Indoor & Outdoor Use



L3HWM1

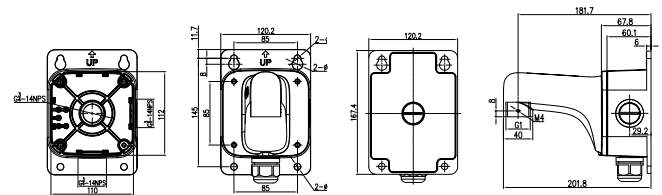

L3HWM1 Lineart

L3PC6 Pendant cap

Features:

- ◆ Pendant Mount for Dome Camera
- ◆ Aluminum Alloy
- ◆ For Indoor & Outdoor Use



L3PC6

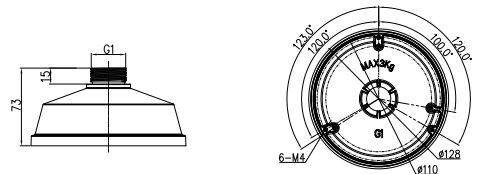

L3PC6 Lineart

L3CPM1 Pendant mount

Features:

- * Requires L3PC6 Pendant Cap
- ◆ 18" Drop Down Length
- ◆ For Use With or Without Drop Down Pipes
- ◆ Includes (2) 9" Drop Down Pipes
- ◆ Manages & Protects Cables
- ◆ For Indoor & Outdoor Use



L3CPM1

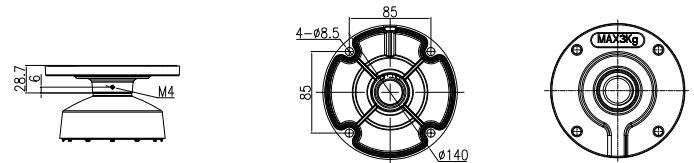

L3CPM1 Lineart

L3POLEMT2 Pole mount

Features:

- ◆ Metal Straps Included
- ◆ For 5-6" Pole Diameters
- ◆ For Indoor & Outdoor Use



L3POLEMT2

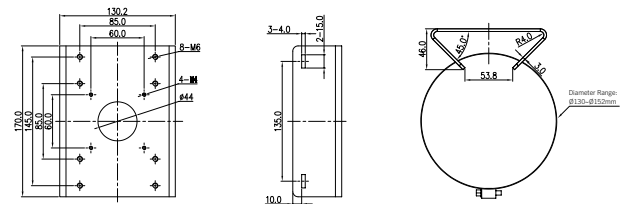

L3POLEMT2 Lineart

TECHNICAL SPECIFICATIONS



L3IP8TS



L3IP8TS4



L3IP8TS/ L3IP8TS4

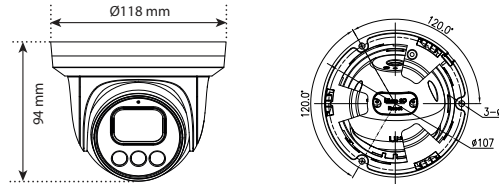

FEATURES:

- ◆ NDAA Compliant
- ◆ Supports AI Face, Body & Vehicle Recognition*
- ◆ True 120dB Wide Dynamic Range
- ◆ 8MP Resolution (3840 x 2160)
- ◆ Fixed 2.8mm or 4mm IR Lens
- ◆ 3 High Power IR LED - 100' IR Range
- ◆ 7 Intelligent Analytics
- ◆ 256GB SD Card Capability
- ◆ H.265 Recording Compression
- ◆ Built in Mic & Alarm
- ◆ PoE - Power over Ethernet
- ◆ Onvif Profile S/G/T Compliant
- ◆ IP66 Weatherproof

INCLUDED ACCESSORIES:

- 1x Quick start guide
- 3x Mounting inserts & screws
- 1x Mounting template
- 1x Network cable cover w/gasket
- 1x 4 Pin Terminal block

	FEATURES	L3IP8TS	L3IP8TS4
Camera	Image Sensor	1/2.8" Progressive Scan CMOS	
	Minimum Illumination	Color: 0.01Lux @(F1.6, AGC ON) , B/W: 0Lux @(IR LED ON)	
	S/N Ratio	55dB	
	IR LED Count / Range / Nanometer	3 High Power IR LEDs / 100' Range / 850nm	
	Shutter Time	1/5s - 1/20,000s	
	Lens (IR Corrective)	Fixed 2.8mm - Angle of View 105°	Fixed 4mm - Angle of View 85°
	Camera Bracket Adjustment	Pan: 0°~355°, Tilt: 0°~80°, Rotation: 0°~360°	
	Day & Night	Yes - True Day/Night with IR Filter - Auto Switch	
	DNR (Digital Noise Reduction)	2DNR & 3DNR, Auto / Manual (0-100 Adjustable)	
	True Wide Dynamic Range (120dB)	On / Off (0-100 Adjustable)	
	BLC (Backlight Compensation)	On / Off (0-100 Adjustable)	
	AI Recognition	* Face, Body & Vehicle Recognition for use with Liberty L3 Series NVRs	
	Intelligent Analytic Features	Perimeter, Single Virtual Fence, Double Virtual Fence, Multi Loitering, Wrong Way, People Counting, Smart Motion	
	Region of Interest	Yes	
	Video Compression	H.265, H.264, MJPEG (for all stream types)	
Audio Compression	G.711, RAW_PCM		
General Functions	Supports Mirror, Aisle Mode, Smart IR, Password Protection, Privacy Mask, Motion Detection		
Resolution/Bitrate	Max. Resolution	8MP (3840x2160)	
	Mainstream Resolution / FPS	3840x2160, 2592x1944, 2592x1520, 2560x1440, 2304x1296, 1920x1080, 1280x720 @ 25/30fps	
	Substream Resolution / FPS	D1, VGA, 640x360, CIF @25/30fps	
	Third Stream Resolution / FPS	VGA, CIF, QVGA @25/30FPS	
	Audio Bitrate	8kbps, 16kbps, 64kbps	
Video Bitrate		Main: 200kbps ~ 16000kbps	
		Sub: 100kbps ~ 6000kbps	
		Third: 100kbps ~ 3000kbps	
Network	Protocols	IPv4/IPv6, 802.1x, HTTP, HTTPS, TCP/IP, UDP/IP, RTSP, DHCP, NTP, RTP/RTCP, PPPoE, SMTP, DNS, UPnP, FTP, ARP, SNMP	
	Users	Up to 10 Users	
	Client Software	Liberty CMS, Liberty-View Mobile App, Liberty Tools	
	Web Browser	<IE11, Chrome, Safari, Edge	
Interface	Communication Interface	1 Ethernet (10/100 Base-T) RJ-45 Connector	
	Audio	1Ch Input/Output (3.5mm) Built in Mic	
	Alarm	1Ch Input/Output (Screw Terminal Connector)	
	Reset Button	Yes	
	Onboard Storage	Yes Built in Micro SD/SDHC/SDXC slot, up to 256GB	
General	Operating Conditions	-40°C ~ 55°C (-40°F ~ 131°F), Less than 90% RH	
	Power Supply	12VDC / POE (IEEE 802.3af)	
	Power Consumption & Current	3.5W (IR LED OFF), 8W Max (IR LED ON)	
	Weatherproof/ Impact Ratings	IP66	
	Housing Material / Color	Aluminum / White	
	Overall Camera Dimensions	Ø4.6" x 3.7" (Ø118x94mm)	
	Net Weight	1.21lb / 550g	
Certifications	CE / FCC / NDAA		

TECHNICAL SPECIFICATIONS



L3IP8TS

L3IP8TS4

Optional Mounting Accessories for L3IP8TS | L3IP8TS4:

L3JB3 Junction box

Features:

- ◆ Manages & Protects Cables
- ◆ 3/4" Conduit Access
- ◆ For Indoor & Outdoor Use



L3JB3

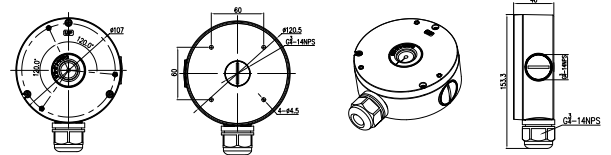

L3JB3 Lineart

L3HWM1 Wall mount

Features:

- * Requires L3PC3 Pendant Cap
- ◆ Manages & Protects Cables
- ◆ Hinged Wall Arm for Easy Installation
- ◆ Side, Back & Bottom 3/4" Conduit Access
- ◆ For Indoor & Outdoor Use



L3HWM1

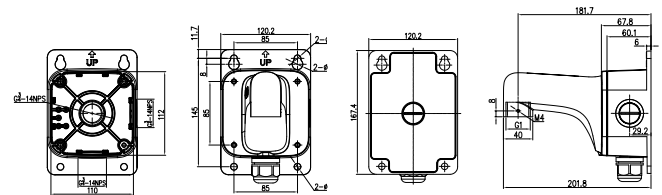

L3HWM1 Lineart

L3PC3 Pendant cap

Features:

- ◆ Pendant Mount for Dome Camera
- ◆ Aluminum Alloy
- ◆ For Indoor & Outdoor Use



L3PC3

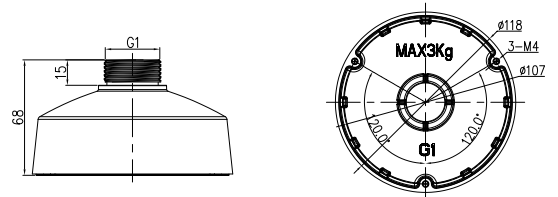

L3PC3 Lineart

L3CPM1 Pendant mount

Features:

- * Requires L3PC3 Pendant Cap
- ◆ 18" Drop Down Length
- ◆ For Use With or Without Drop Down Pipes
- ◆ Includes (2) 9" Drop Down Pipes
- ◆ Manages & Protects Cables
- ◆ For Indoor & Outdoor Use



L3CPM1

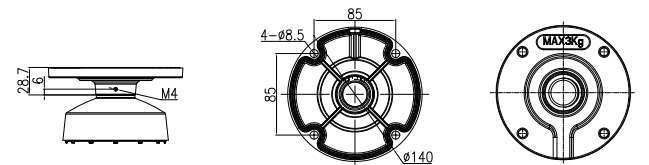

L3CPM1 Lineart

L3POLEMT2 Pole mount

Features:

- ◆ Metal Straps Included
- ◆ For 5-6" Pole Diameters
- ◆ For Indoor & Outdoor Use



L3POLEMT2

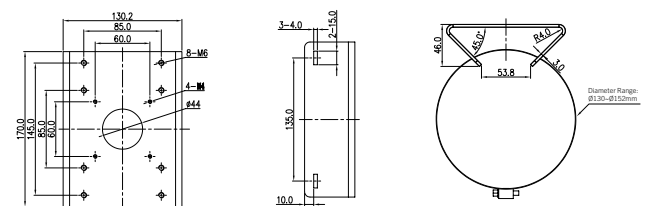

L3POLEMT2 Lineart

TECHNICAL SPECIFICATIONS



L3IP8VFBS



L3IP8VFBS

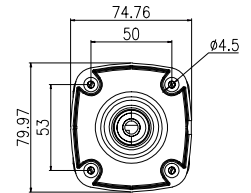
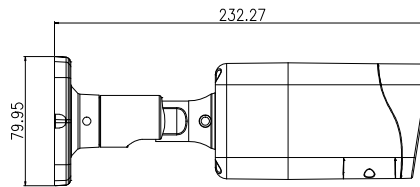

FEATURES:

- ◆ NDAA Compliant
- ◆ Supports AI Face, Body & Vehicle Recognition*
- ◆ True 120dB Wide Dynamic Range
- ◆ 8MP Resolution (3840 x 2160)
- ◆ Auto Focus 2.7 ~ 13.5mm IR Lens
- ◆ 4 High Power IR LED - 120' IR Range
- ◆ 7 Intelligent Analytics
- ◆ 256GB SD Card Capability
- ◆ H.265 Recording Compression
- ◆ Audio Line In/Out & Alarm
- ◆ PoE - Power over Ethernet
- ◆ Onvif Profile S/G/T Compliant
- ◆ IP67 Weatherproof

INCLUDED ACCESSORIES:

- 1x Quick start guide
- 2x Hex wrench
- 4x Mounting inserts & screws
- 1x Mounting template
- 1x Network cable cover w/gasket
- 1x 4 Pin Terminal block

	FEATURES	L3IP4VFBS
Camera	Image Sensor	1/2.8" Progressive Scan CMOS
	Minimum Illumination	Color: 0.01Lux @(F1.6, AGC ON) , B/W: 0Lux @(IR LED ON)
	S/N Ratio	55dB
	IR LED Count / Range / Nanometer	4 High Power IR LED's / 120' Range / 850nm
	Shutter Time	1/5s - 1/20,000s
	Lens (IR Corrective)	Autofocus 2.7-13.5mm with Remote Zoom / H: 34.3° - 103°
	Camera Bracket Adjustment	Pan: 0°~360°, Tilt: 0°~90°, Rotation: 0°~360°
	Day & Night	Yes - True Day/Night with IR Filter - Auto Switch
	DNR (Digital Noise Reduction)	2DNR & 3DNR, Auto / Manual (0-100 Adjustable)
	True Wide Dynamic Range (120dB)	On / Off (0-100 Adjustable)
	BLC (Backlight Compensation)	On / Off (0-100 Adjustable)
	AI Recognition	* Face, Body & Vehicle Recognition for use with Liberty L3 Series NVRs
	Intelligent Analytic Features	Perimeter, Single Virtual Fence, Double Virtual Fence, Multi Loitering, Wrong Way, People Counting, Smart Motion
	Region of Interest	Yes
Resolution/Bitrate	Video Compression	H.265, H.264, MJPEG (for all stream types)
	Audio Compression	G.711, RAW_PCM
	General Functions	Supports Mirror, Aisle Mode, Smart IR, Password Protection, Privacy Mask, Motion Detection
	Max. Resolution	8MP (3840x2160)
	Mainstream Resolution / FPS	3840x2160, 2592x1944, 2592x1520, 2560x1440, 2304x1296, 1920x1080, 1280x720 @ 25/30fps
Video Bitrate	Substream Resolution / FPS	D1, VGA, 640x360, CIF @25/30fps
	Third Stream Resolution / FPS	VGA, CIF, QVGA @25/30FPS
	Audio Bitrate	8kbps, 16kbps, 64kbps
Network	Video Bitrate	Main: 500kbps ~ 16000kbps Sub: 100kbps ~ 6000kbps Third: 100kbps ~ 3000kbps
	Protocols	IPv4/IPv6, 802.1x, HTTP, HTTPS, TCP/IP, UDP/IP, RTSP, DHCP, NTP, RTCP/ RTP, PPPoE, SMTP, DNS, UPnP, FTP, ARP, SNMP
	Users	Up to 10 Users
	Client Software	Liberty CMS, Liberty-View Mobile App, Liberty Tools
Interface	Web Browser	<IE11, Chrome, Safari, Edge
	Communication Interface	1 Ethernet (10/100 Base-T) RJ-45 Connector
	Audio	1Ch Input/Output (3.5mm)
	Alarm	1Ch Input/Output (Screw Terminal Connector)
	Reset Button	Yes
General	Onboard Storage	Yes Built in Micro SD/SDHC/SDXC slot, up to 256GB
	Operating Conditions	-40°C ~ 55°C (-40°F ~ 131°F) , Less than 90% RH
	Power Supply	12VDC / POE (IEEE 802.3af)
	Power Consumption & Current	3.5W (IR LED OFF), 8W Max (IR LED ON)
	Weatherproof/ Impact Ratings	IP67
	Housing Material / Color	Aluminum / White
	Overall Camera Dimensions	9.1" x 2.9" x 3.1" (232 x 74.8 x 80mm)
	Net Weight	1.79lb / 810g
Certifications	CE / FCC / NDAA	

TECHNICAL SPECIFICATIONS



L3IP8VFBS

Optional Mounting Accessories for L3IP8VFBS:

L3JB1 Junction box

Features:

- ◆ Manages & Protects Cables
- ◆ 3/4" Conduit Access
- ◆ For Indoor & Outdoor Use



L3JB1

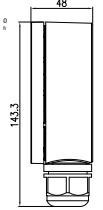
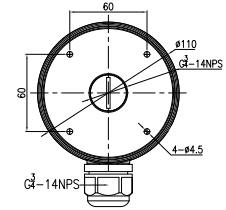
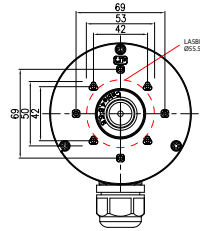

L3JB1 Lineart

L3POLEMT2 Pole mount

Features:

- ◆ Metal Straps Included
- ◆ For 5-6" Pole Diameters
- ◆ For Indoor & Outdoor Use



L3POLEMT2

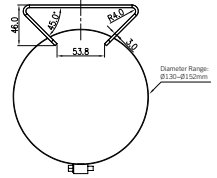
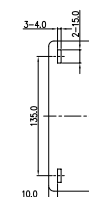
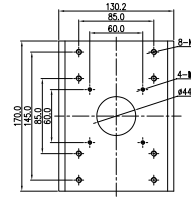

L3POLEMT2 Lineart

TECHNICAL SPECIFICATIONS



L3IP8VFDS



L3IP8VFDS

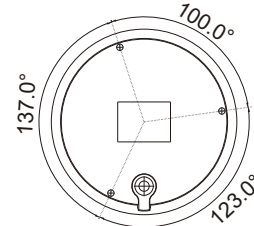
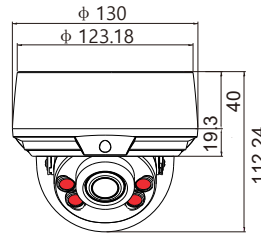

FEATURES:

- ◆ NDAA Compliant
- ◆ Supports AI Face, Body & Vehicle Recognition*
- ◆ True 120dB Wide Dynamic Range
- ◆ 8MP Resolution (3840 x 2160)
- ◆ Auto Focus 2.7 ~ 13.5mm IR Lens
- ◆ 4 High Power IR LED - 120' IR Range
- ◆ 7 Intelligent Analytics
- ◆ 256GB SD Card Capability
- ◆ H.265 Recording Compression
- ◆ Audio Line In/Out & Alarm
- ◆ PoE - Power over Ethernet
- ◆ Onvif Profile S/G/T Compliant
- ◆ IK10 Rated & IP66 Weatherproof

INCLUDED ACCESSORIES:

- 1x Quick start guide
- 1x T15 Wrench
- 3x Mounting inserts & screws
- 3x Mounting accessory screws
- 1x Mounting template
- 1x Network cable cover w/gasket
- 1x 4 Pin Terminal block

	FEATURES	L3IP8VFDS
Camera	Image Sensor	1/2.8" Progressive Scan CMOS
	Minimum Illumination	Color: 0.01Lux @(F1.6, AGC ON) , B/W: 0Lux @(IR LED ON)
	S/N Ratio	55dB
	IR LED Count / Range / Nanometer	4 High Power IR LED's / 120' Range / 850nm
	Shutter Time	1/5s - 1/20,000s
	Lens (IR Corrective)	Autofocus 2.7-13.5mm with Remote Zoom / H: 34.3° - 103°
	Camera Bracket Adjustment	Pan: 0°~355°, Tilt: 0°~75°, Rotation: 0°~355°
	Day & Night	Yes - True Day/Night with IR Filter - Auto Switch
	DNR (Digital Noise Reduction)	2DNR & 3DNR, Auto / Manual (0-100 Adjustable)
	True Wide Dynamic Range (120dB)	On / Off (0-100 Adjustable)
	BLC (Backlight Compensation)	On / Off (0-100 Adjustable)
	AI Recognition	* Face, Body & Vehicle Recognition for use with Liberty L3 Series NVRs
	Intelligent Analytic Features	Perimeter, Single Virtual Fence, Double Virtual Fence, Multi Loitering, Wrong Way, People Counting, Smart Motion
	Region of Interest	Yes
Resolution/Bitrate	Video Compression	H.265, H.264, MJPEG (for all stream types)
	Audio Compression	G.711, RAW_PCM
	General Functions	Supports Mirror, Aisle Mode, Smart IR, Password Protection, Privacy Mask, Motion Detection
	Max. Resolution	8MP (3840x2160)
	Mainstream Resolution / FPS	3840x2160, 2592x1944, 2592x1520, 2560x1440, 2304x1296, 1920x1080, 1280x720 @ 25/30fps
Video Bitrate	Substream Resolution / FPS	D1, VGA, 640x360, CIF @25/30fps
	Third Stream Resolution / FPS	VGA, CIF, QVGA @25/30FPS
	Audio Bitrate	8kbps, 16kbps, 64kbps
Network	Video Bitrate	Main: 500kbps ~ 16000kbps Sub: 100kbps ~ 6000kbps Third: 100kbps ~ 3000kbps
	Protocols	IPv4/IPv6, 802.1x, HTTP, HTTPS, TCP/IP, UDP/IP, RTSP, DHCP, NTP, RTCP/ RTP, PPPoE, SMTP, DNS, UPnP, FTP, ARP, SNMP
	Users	Up to 10 Users
	Client Software	Liberty CMS, Liberty-View Mobile App, Liberty Tools
Interface	Web Browser	<IE11, Chrome, Safari, Edge
	Communication Interface	1 Ethernet (10/100 Base-T) RJ-45 Connector
	Audio	1Ch Input/Output (3.5mm)
	Alarm	1Ch Input/Output (Screw Terminal Connector)
	Reset Button	Yes
General	Onboard Storage	Yes Built in Micro SD/SDHC/SDXC slot, up to 256GB
	Operating Conditions	-40°C ~ 55°C (-40°F ~ 131°F) , Less than 90% RH
	Power Supply	12VDC / POE (IEEE 802.3af)
	Power Consumption & Current	3.5W (IR LED OFF), 8.5W Max (IR LED ON)
	Weatherproof/ Impact Ratings	IP67 / IK10
	Housing Material / Color	Aluminum / White
	Overall Camera Dimensions	Ø5.1" x 4.4" (Ø130 x 112mm)
Net Weight	1.7lb / 800g	
Certifications	CE / FCC / NDAA	

TECHNICAL SPECIFICATIONS



L3IP8VFDS

Optional Mounting Accessories for L3IP8VFDS:

L3JB5 Junction box

Features:

- ◆ Manages & Protects Cables
- ◆ 3/4" Conduit Access
- ◆ For Indoor & Outdoor Use



L3JB5

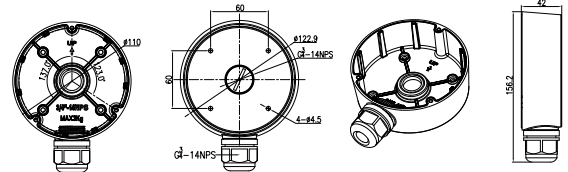

L3JB5 Lineart

L3HWM1 Wall mount

Features:

- * Requires L3PC5 Pendant Cap
- ◆ Manages & Protects Cables
- ◆ Hinged Wall Arm for Easy Installation
- ◆ Side, Back & Bottom 3/4" Conduit Access
- ◆ For Indoor & Outdoor Use



L3HWM1

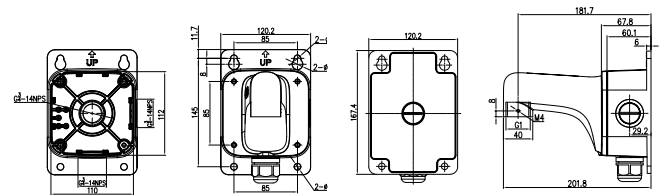

L3HWM1 Lineart

L3PC5 Pendant cap

Features:

- ◆ Pendant Mount for Dome Camera
- ◆ Aluminum Alloy
- ◆ For Indoor & Outdoor Use



L3PC5

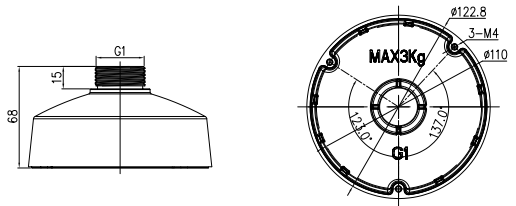

L3PC5 Lineart

L3CPM1 Pendant mount

Features:

- * Requires L3PC5 Pendant Cap
- ◆ 18" Drop Down Length
- ◆ For Use With or Without Drop Down Pipes
- ◆ Includes (2) 9" Drop Down Pipes
- ◆ Manages & Protects Cables
- ◆ For Indoor & Outdoor Use



L3CPM1

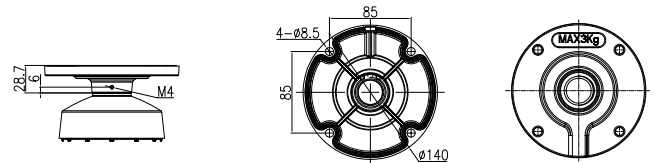

L3CPM1 Lineart

L3POLEMT2 pole mount

Features:

- ◆ Metal Straps Included
- ◆ For 5-6" Pole Diameters
- ◆ For Indoor & Outdoor Use



L3POLEMT2

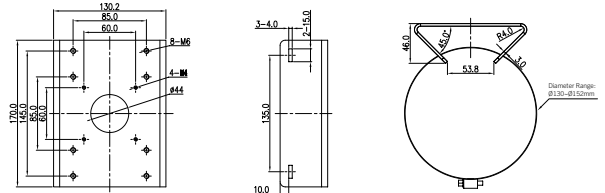

L3POLEMT2 Lineart

TECHNICAL SPECIFICATIONS



L3IP8WS



L3IP8WS

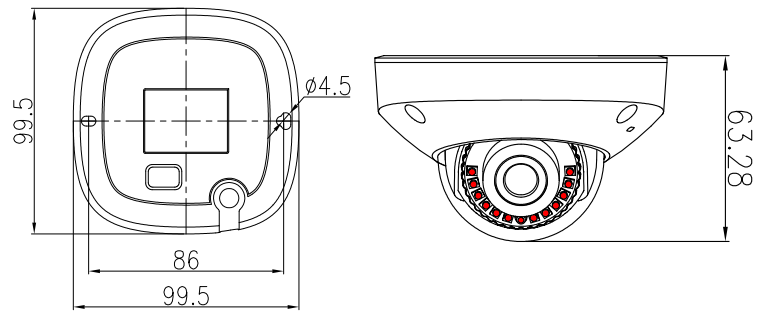

FEATURES:

- ◆ NDAA Compliant
- ◆ Supports AI Face, Body & Vehicle Recognition*
- ◆ True 120dB Wide Dynamic Range
- ◆ 8MP Resolution (3840 x 2160)
- ◆ Fixed 2.8mm IR Lens
- ◆ 12 IR LED - 45' IR Range
- ◆ 7 Intelligent Analytics
- ◆ 256GB SD Card Capability
- ◆ H.265 Recording Compression
- ◆ Built in Mic & Alarm
- ◆ PoE - Power over Ethernet
- ◆ Onvif Profile S/G/T Compliant
- ◆ IP66 Weatherproof

INCLUDED ACCESSORIES:

- 1x Quick start guide
- 1x T10 Wrench
- 2x Mounting inserts & screws
- 1x Mounting template
- 1x Network cable cover w/gasket
- 1x 4 Pin Terminal block

	FEATURES	L3IP8WS
Camera	Image Sensor	1/2.8" Progressive Scan CMOS
	Minimum Illumination	Color: 0.01Lux @(F1.6, AGC ON) , B/W: 0Lux @(IR LED ON)
	S/N Ratio	55dB
	IR LED Count / Range / Nanometer	12 IR LEDs / 45' Range / 850nm
	Shutter Time	1/5s - 1/20,000s
	Lens (IR Corrective)	Fixed 2.8mm - Angle of View 105°
	Camera Bracket Adjustment	Pan: 90°, Tilt: 0° ~ 72°, Rotation: 0° ~ 360°
	Day & Night	Yes - True Day/Night with IR Filter - Auto Switch
	DNR (Digital Noise Reduction)	2DNR & 3DNR, Auto / Manual (0-100 Adjustable)
	True Wide Dynamic Range (120dB)	On / Off (0-100 Adjustable)
	BLC (Backlight Compensation)	On / Off (0-100 Adjustable)
	AI Recognition	* Face, Body & Vehicle Recognition for use with Liberty L3 Series NVRs
	Intelligent Analytic Features	Perimeter, Single Virtual Fence, Double Virtual Fence, Multi Loitering, Wrong Way, People Counting, Smart Motion
	Region of Interest	Yes
Resolution/Bitrate	Video Compression	H.265, H.264, MJPEG (for all stream types)
	Audio Compression	G.711, RAW_PCM
	General Functions	Supports Mirror, Aisle Mode, Smart IR, Password Protection, Privacy Mask, Motion Detection
	Max. Resolution	8MP (3840x2160)
	Mainstream Resolution / FPS	3840x2160, 2592x1944, 2592x1520, 2560x1440, 2304x1296, 1920x1080, 1280x720 @ 25/30fps
	Substream Resolution / FPS	D1, VGA, 640x360, CIF @25/30fps
Network	Third Stream Resolution / FPS	VGA, CIF, QVGA @25/30FPS
	Audio Bitrate	8kbps, 16kbps, 64kbps
	Video Bitrate	Main: 200kbps ~ 16000kbps
		Sub: 100kbps ~ 6000kbps
Third: 100kbps ~ 3000kbps		
Interface	Protocols	IPv4/IPv6, 802.1x, HTTP, HTTPS, TCP/IP, UDP/IP, RTSP, DHCP, NTP, RTP/RTCP, PPPoE, SMTP, DNS, UPnP, FTP, ARP, SNMP
	Users	Up to 10 Users
	Client Software	Liberty CMS, Liberty-View Mobile App, Liberty Tools
	Web Browser	<IE11, Chrome, Safari, Edge
	Communication Interface	1 Ethernet (10/100 Base-T) RJ-45 Connector
General	Audio	1Ch Input/Output (3.5mm) Built in Mic
	Alarm	1Ch Input/Output (Screw Terminal Connector)
	Reset Button	Yes
	Onboard Storage	Yes Built in Micro SD/SDHC/SDXC slot, up to 256GB
	Operating Conditions	-40°C ~ 55°C (-40°F ~ 131°F) , Less than 90% RH
	Power Supply	12VDC / POE (IEEE 802.3af)
	Power Consumption & Current	3.5W (IR LED OFF), 5W Max (IR LED ON)
	Weatherproof/ Impact Ratings	IP66
	Housing Material / Color	Metal Body with Plastic Cover / White
	Overall Camera Dimensions	3.9" x 3.9" x 2.4" (99.5 x 99.5 x 63mm)
Net Weight	0.84lb / 380g	
Certifications	CE / FCC / NDAA	

TECHNICAL SPECIFICATIONS



L3IP8WS

Optional Mounting Accessories for L3IP8WS:

L3JB4 Junction box

Features:

- ◆ Manages & Protects Cables
- ◆ 3/4" Conduit Access
- ◆ For Indoor & Outdoor Use



L3JB4

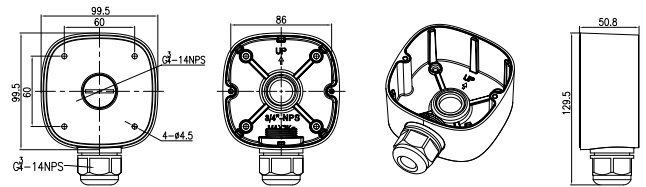

L3JB4 Lineart

L3HWM1 Wall mount

Features:

- * Requires L3PC4 Pendant Cap
- ◆ Manages & Protects Cables
- ◆ Hinged Wall Arm for Easy Installation
- ◆ Side, Back & Bottom 3/4" Conduit Access
- ◆ For Indoor & Outdoor Use



L3HWM1

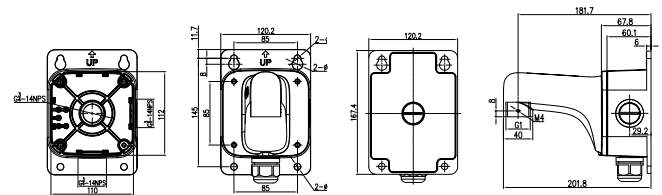

L3HWM1 Lineart

L3PC4 Pendant cap

Features:

- ◆ Pendant Mount for Wedge Camera
- ◆ Aluminum Alloy
- ◆ For Indoor & Outdoor Use



L3PC4

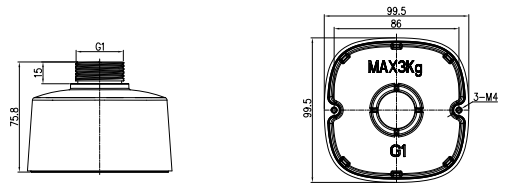

L3PC4 Lineart

L3CPM1 Pendant mount

Features:

- * Requires L3PC4 Pendant Cap
- ◆ 18" Drop Down Length
- ◆ For Use With or Without Drop Down Pipes
- ◆ Includes (2) 9" Drop Down Pipes
- ◆ Manages & Protects Cables
- ◆ For Indoor & Outdoor Use



L3CPM1

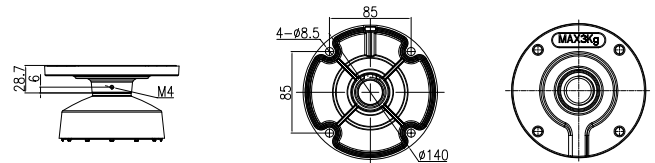

L3CPM1 Lineart

L3POLEMT2 Pole mount

Features:

- ◆ Metal Straps Included
- ◆ For 5-6" Pole Diameters
- ◆ For Indoor & Outdoor Use



L3POLEMT2

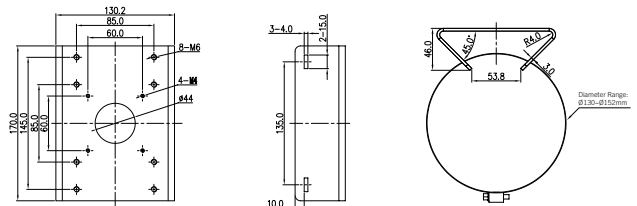

L3POLEMT2 Lineart